

Hanko Sauna SQ

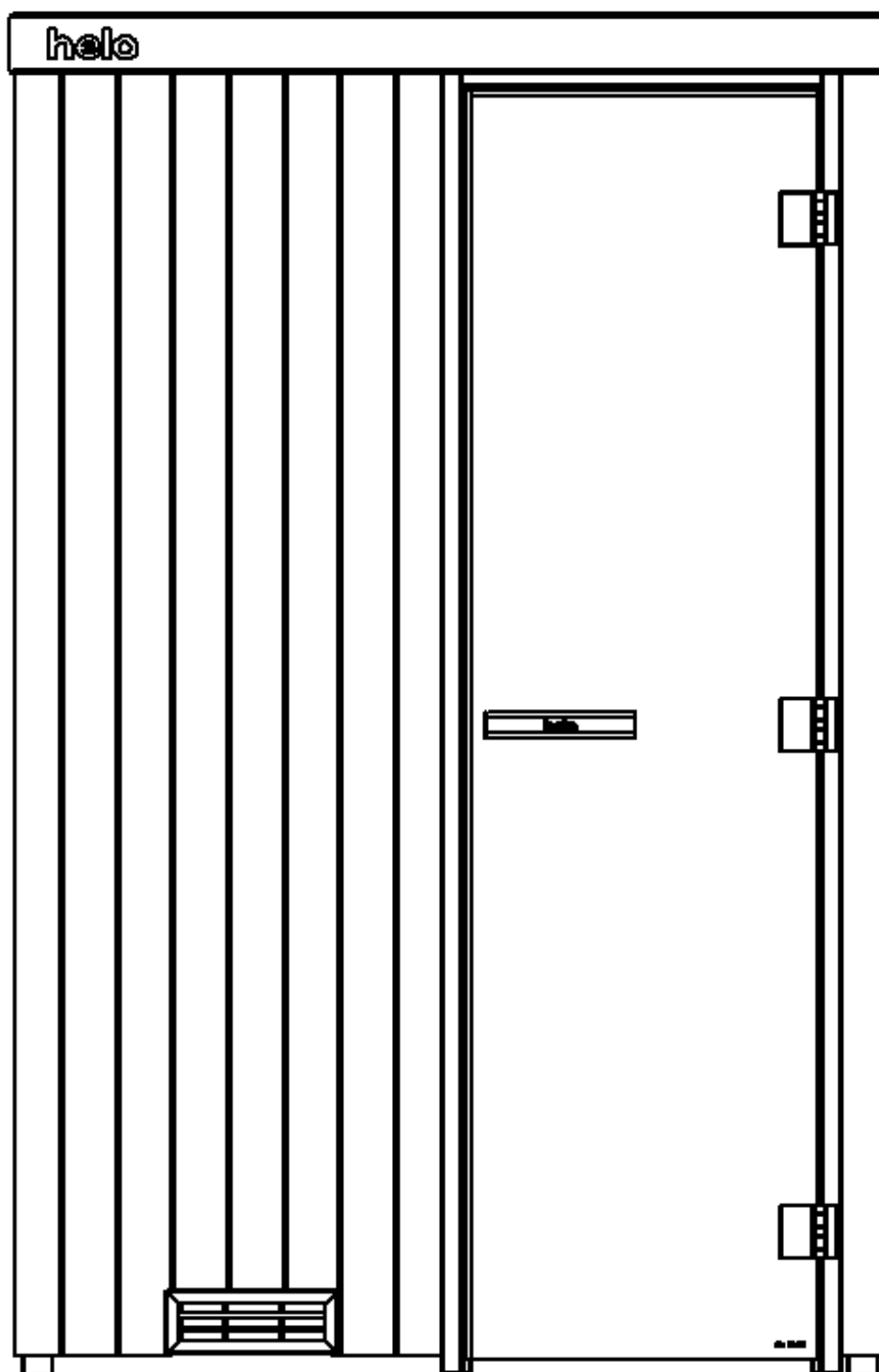

Wall numbering

The wall panels are numbered on their sides, corresponding to the layout diagram below.

Numbers on each box indicate which wall panels it contains.

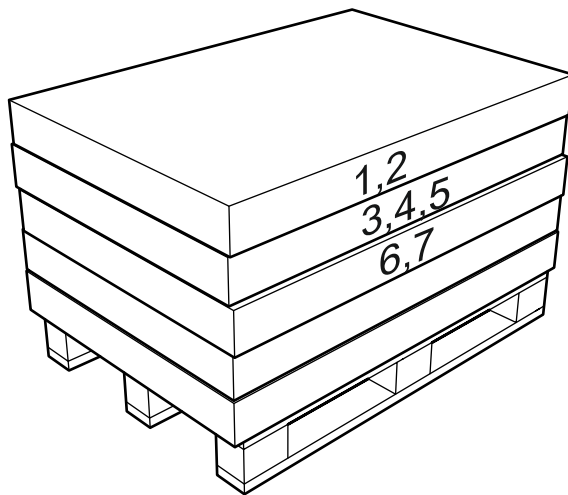
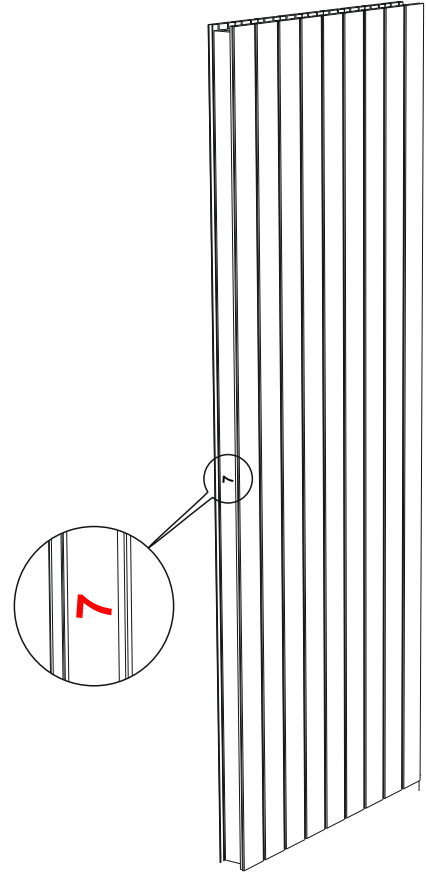
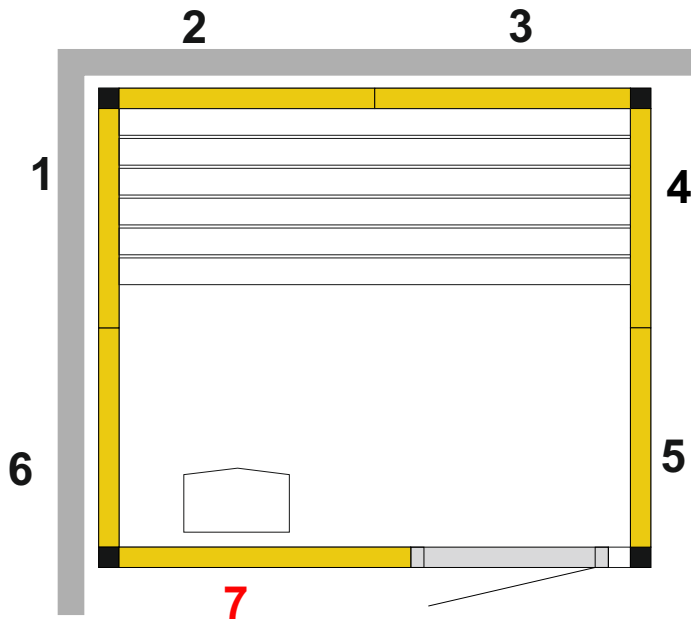

Wall section for heater

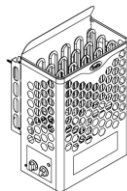
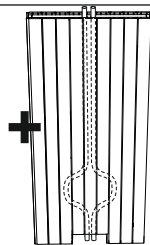

Information

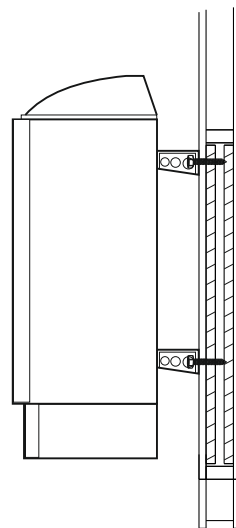
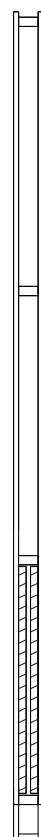
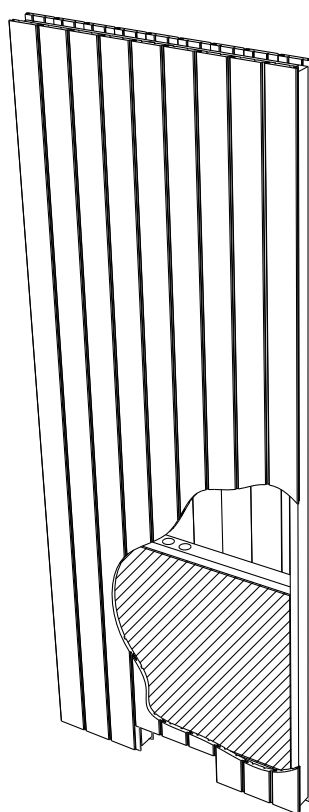
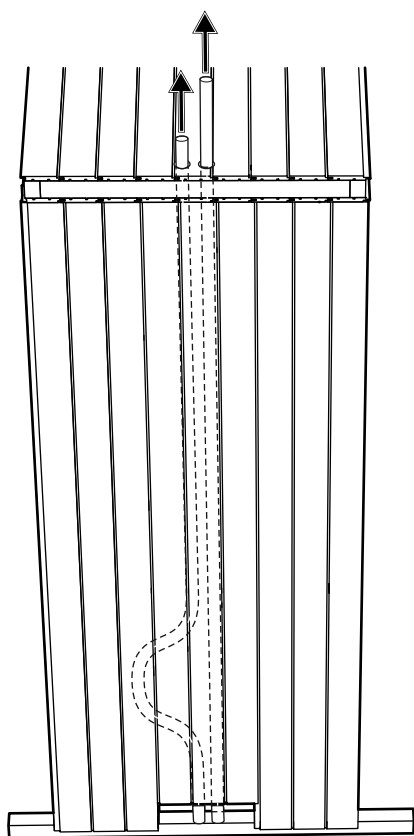
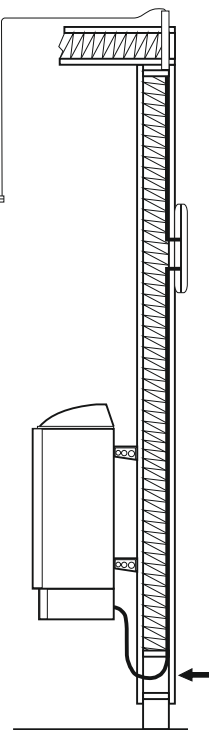
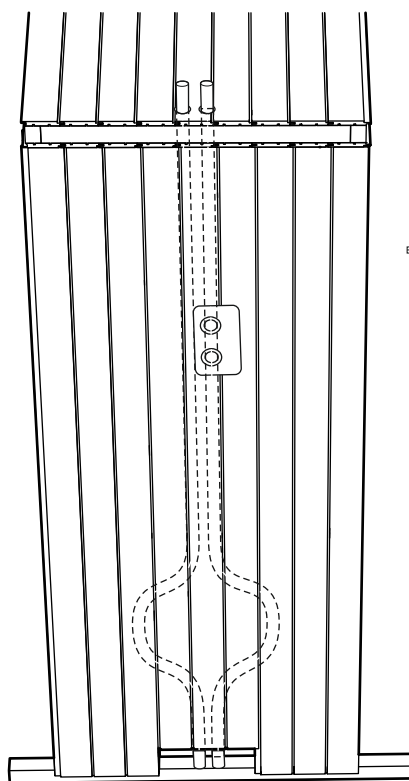
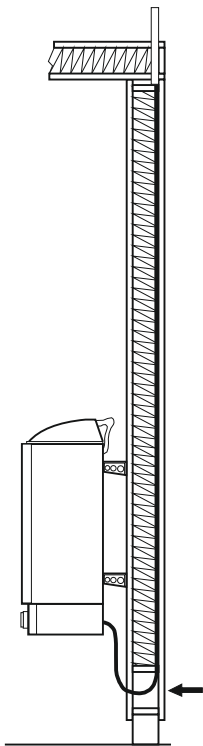
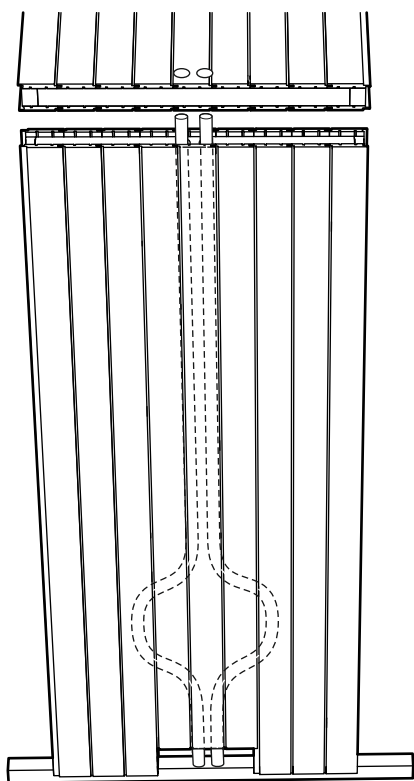

Tip!

Information

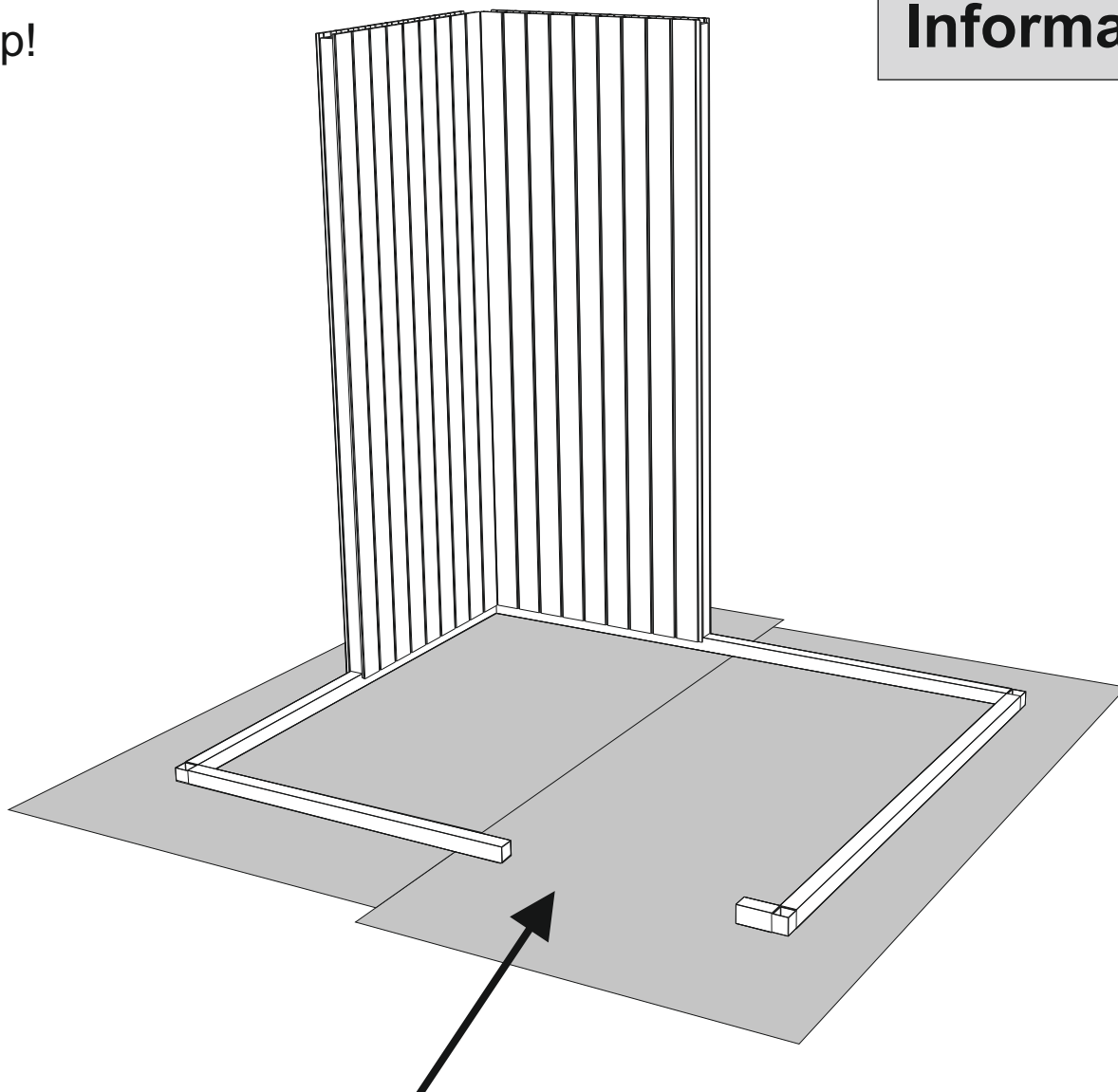

Cardboard packaging

Use as floor protection
during assembly.

Wall panel - quality

① Both inside and outside surfaces visible - quality A

② Only external visible - quality C

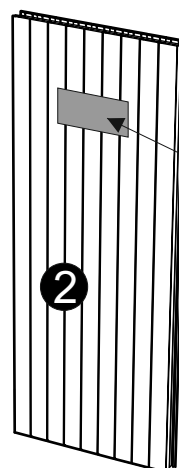
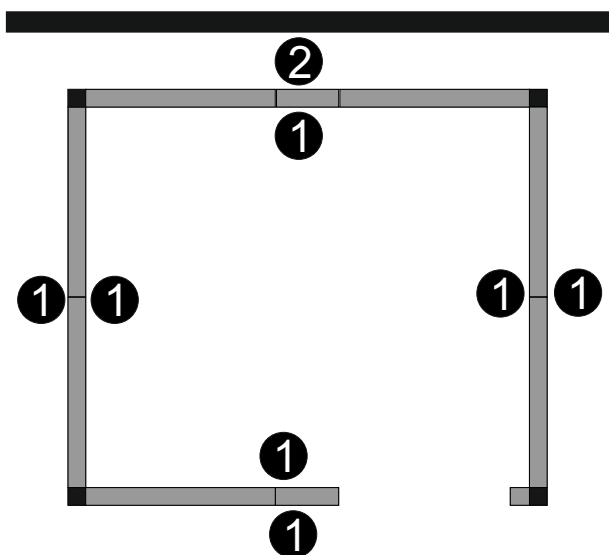

See panel
label for information

Panel direction

Panel direction varies according to room orientation
Also, see enclosed layout.

Information

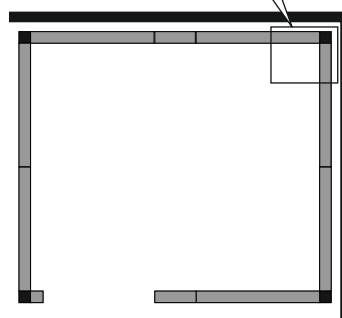
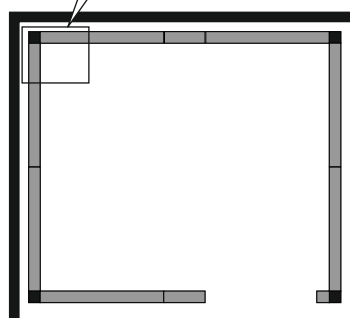
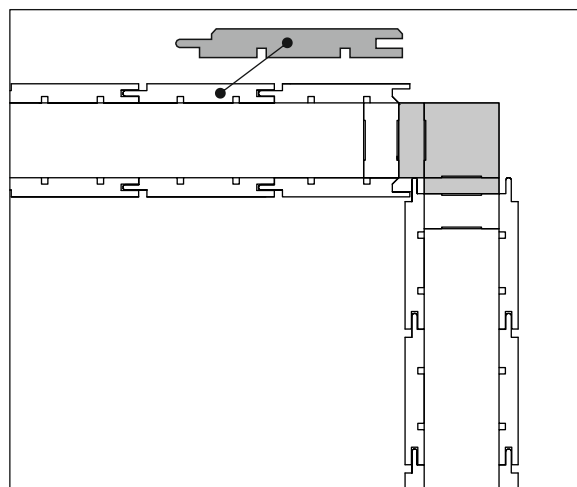
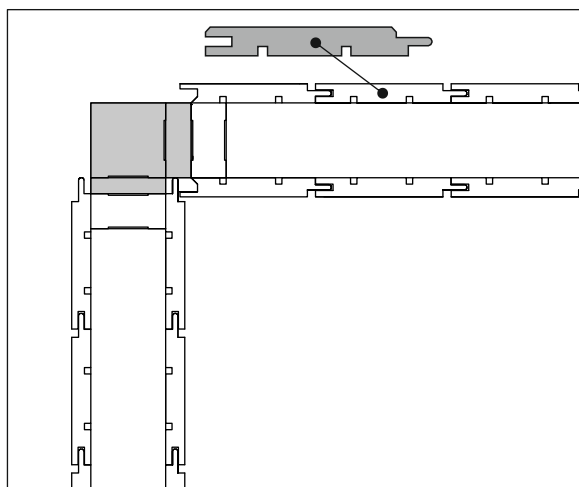

Mounting plate

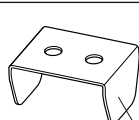

Mounting plate - corner

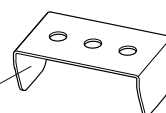

Mounting plate - between walls

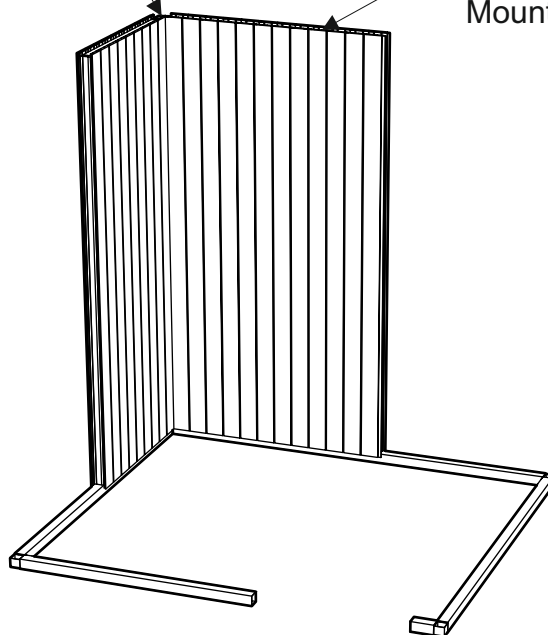

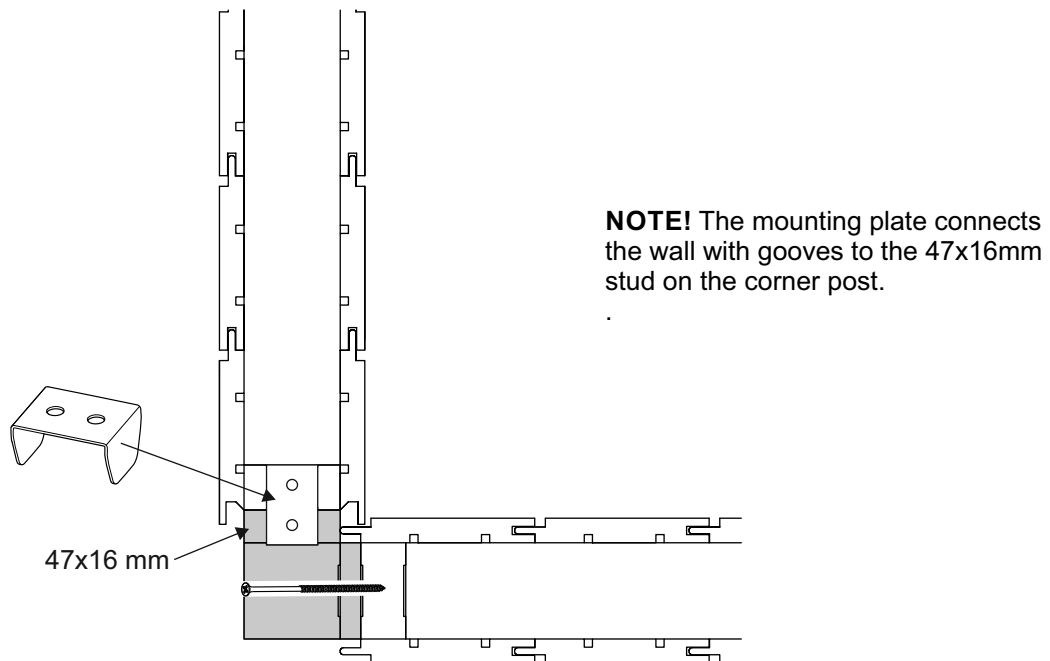
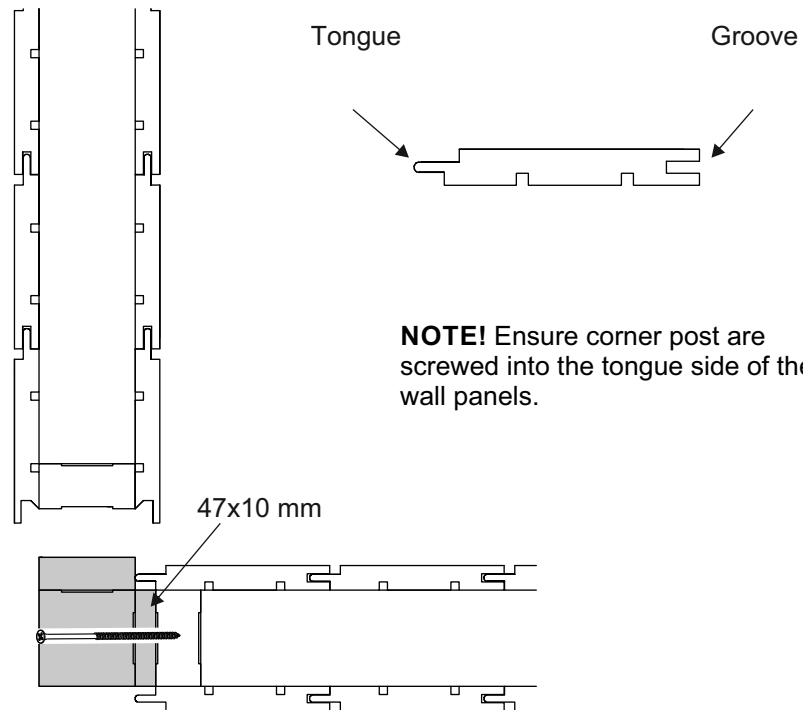

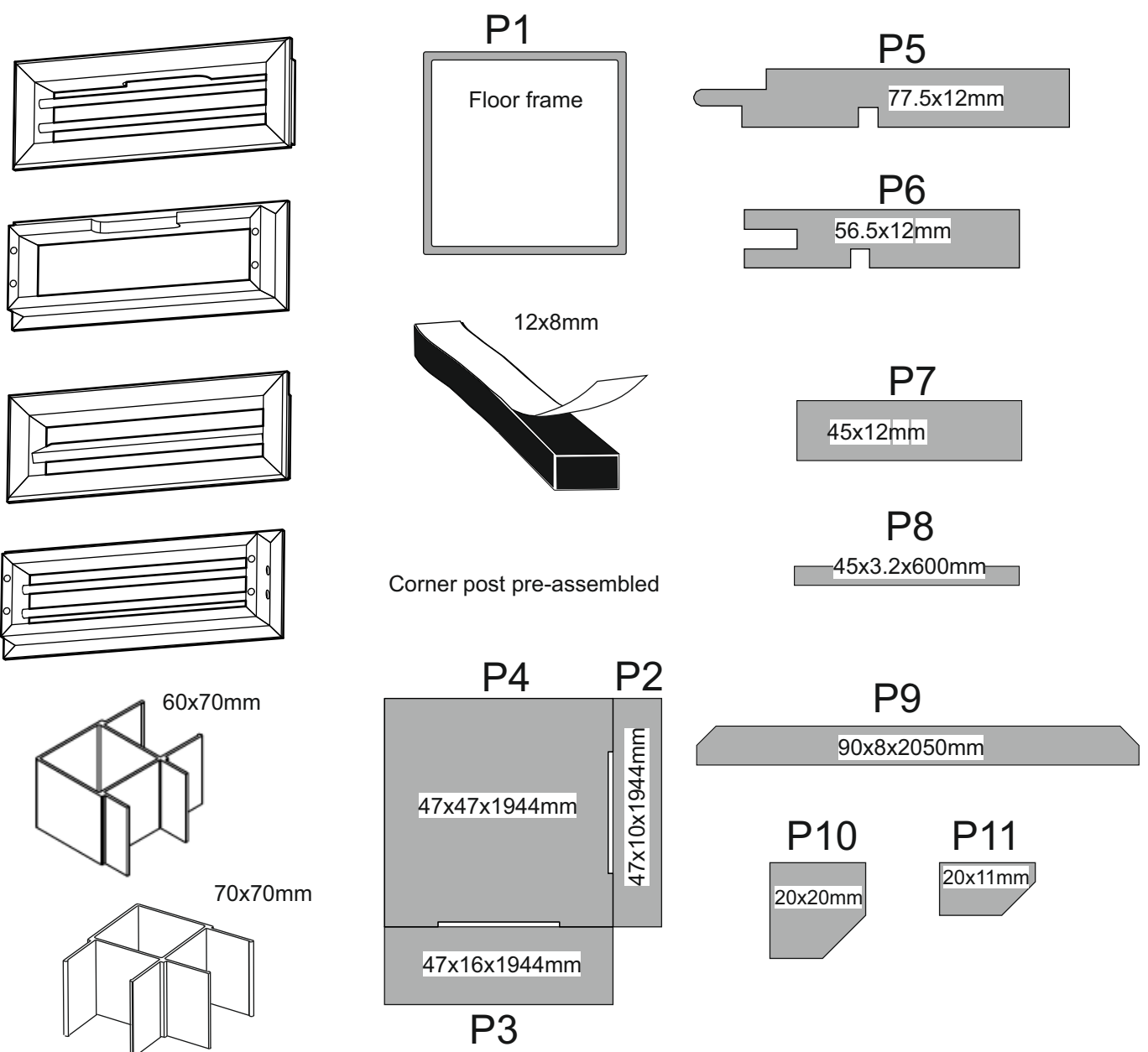
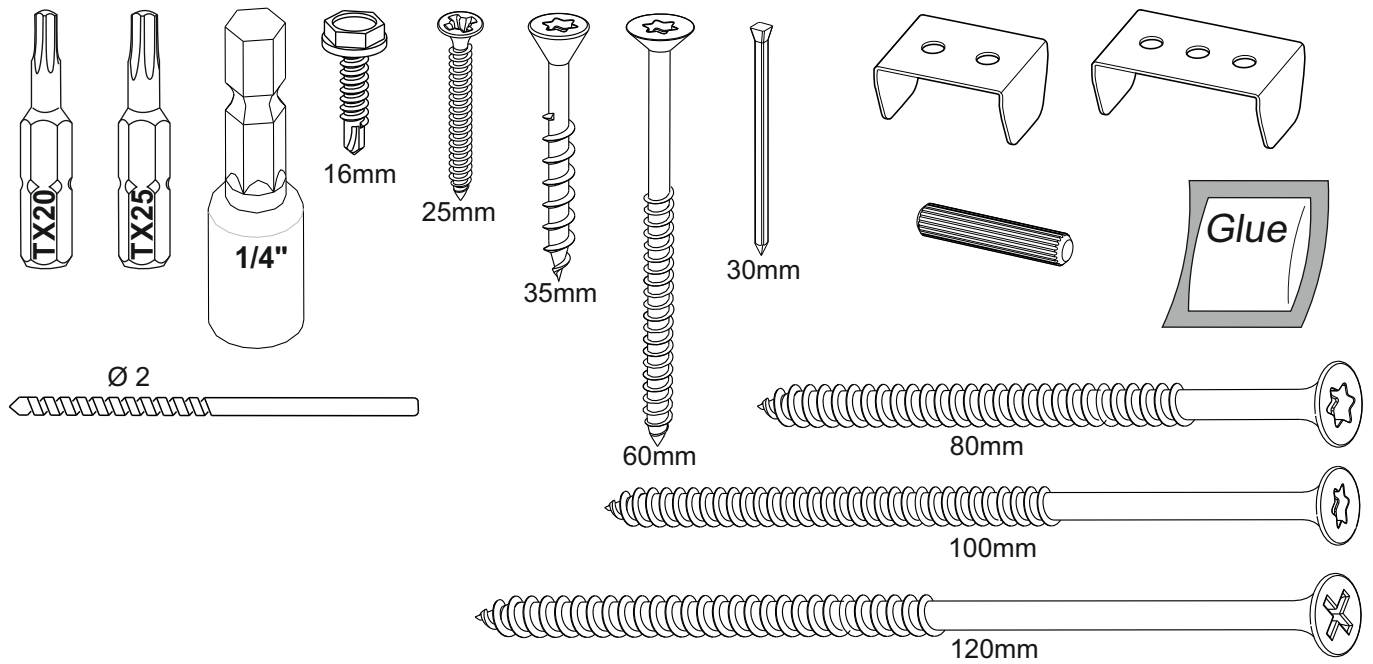

1 P1

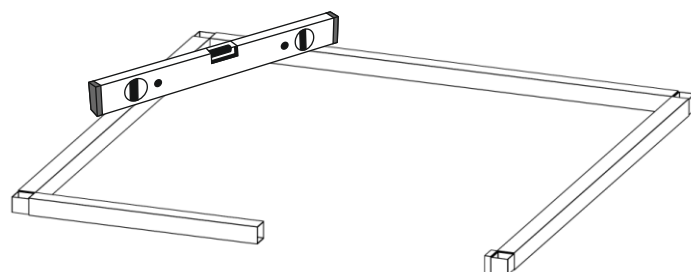
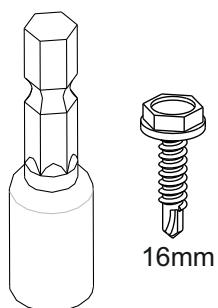
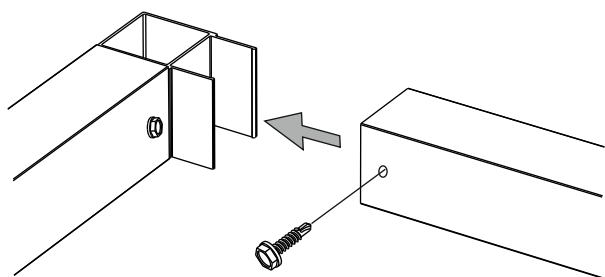
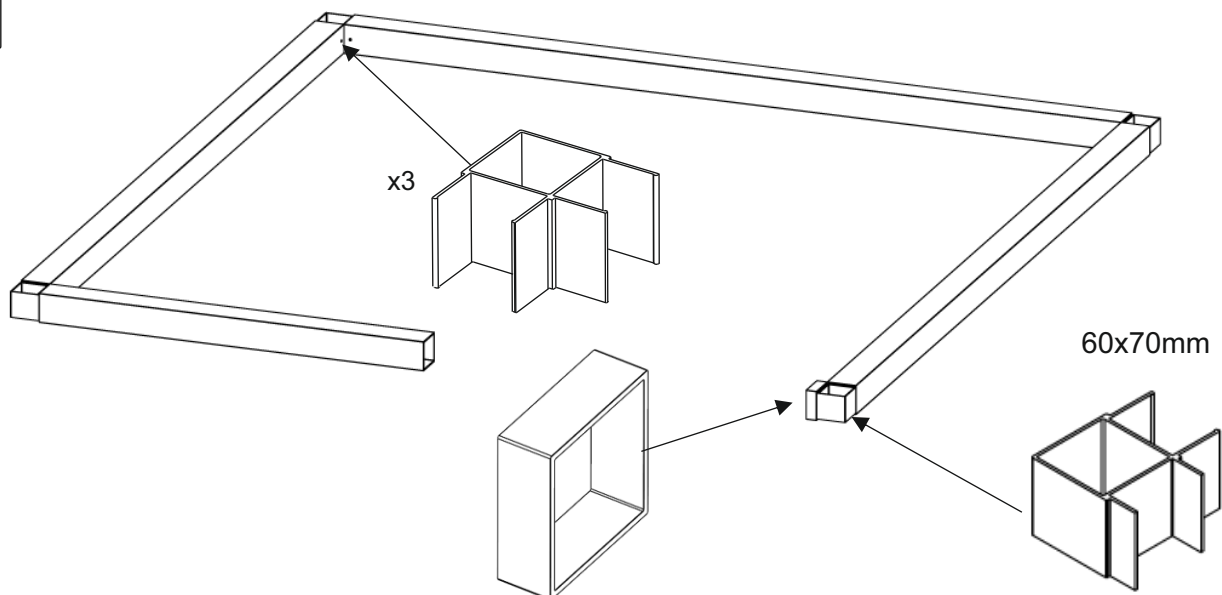
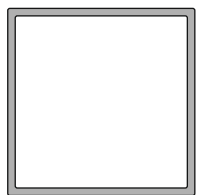

Corner posts

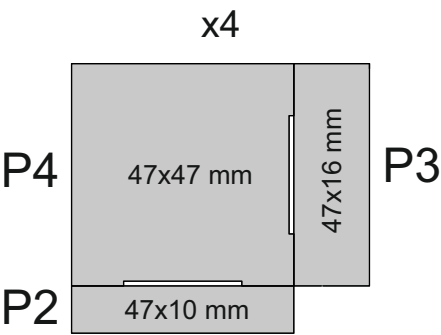

Pre-assembled

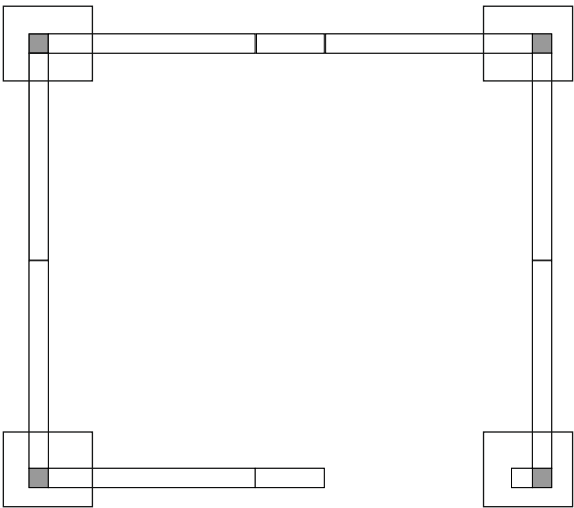

Mounting corners - It is always recommended that the corner posts and walls are screwed together. If Space is limited, walls can be assembled and then slid into the correct location.

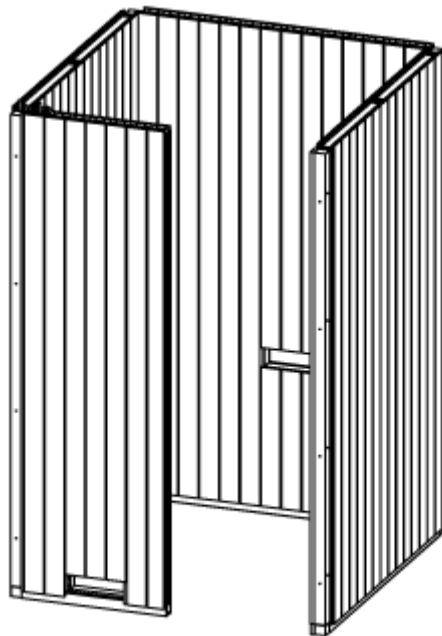
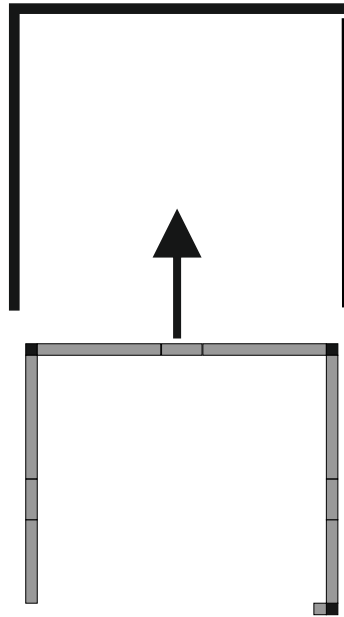
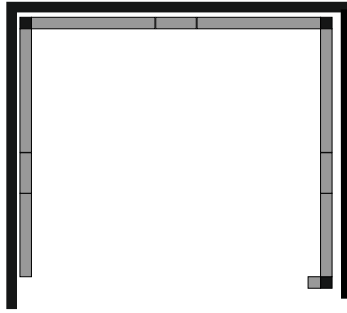

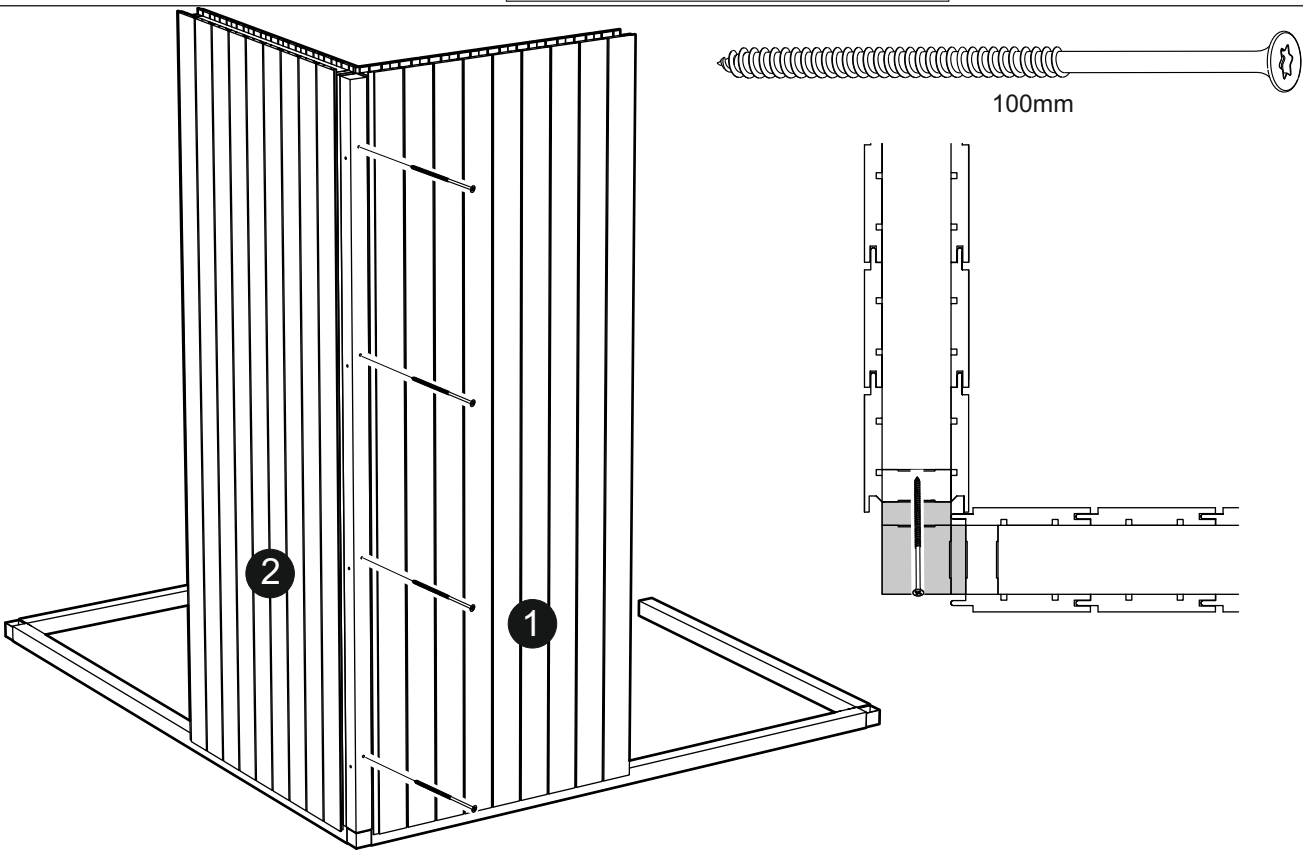
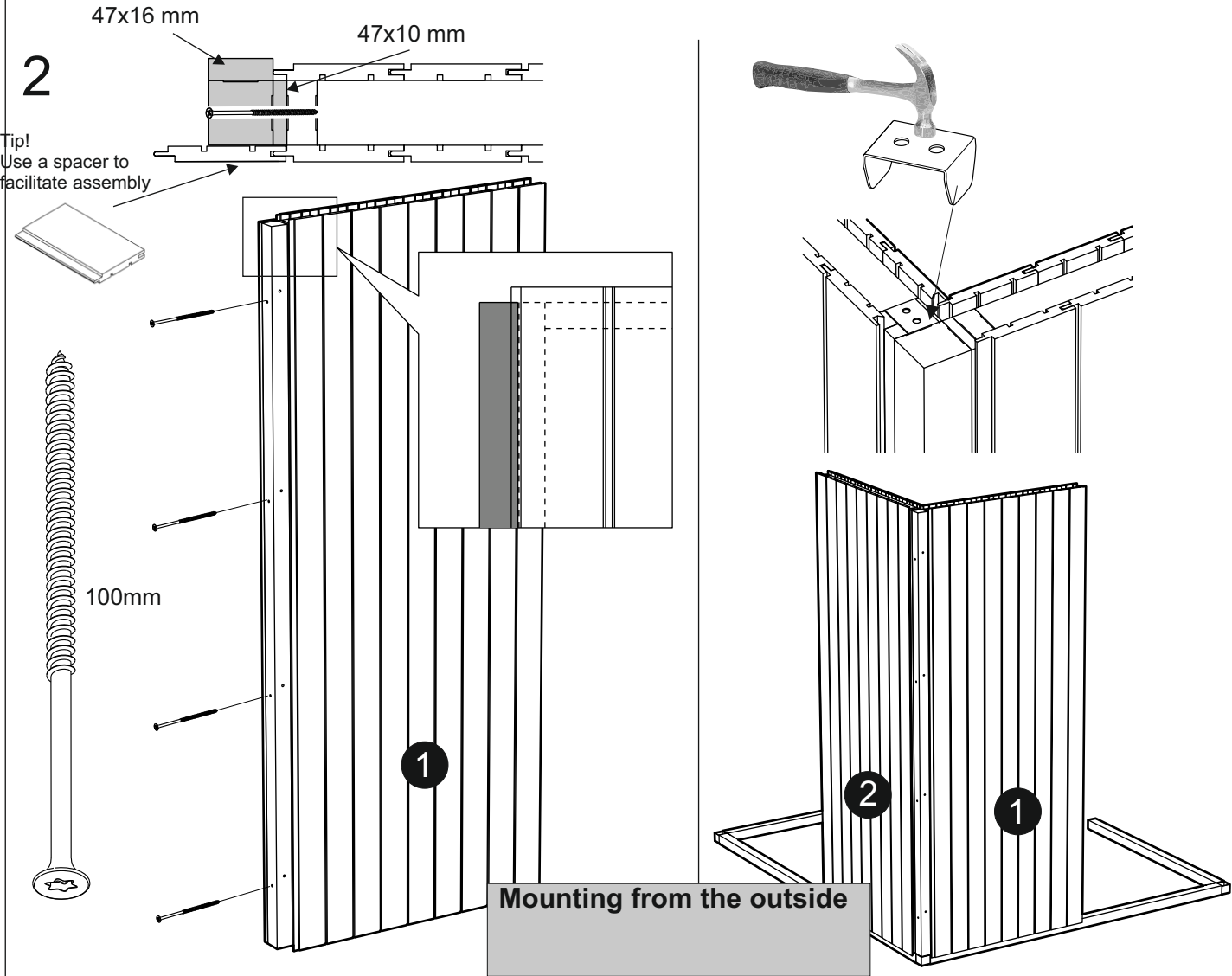

3

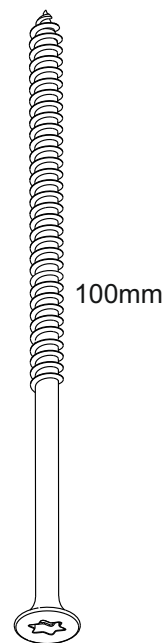
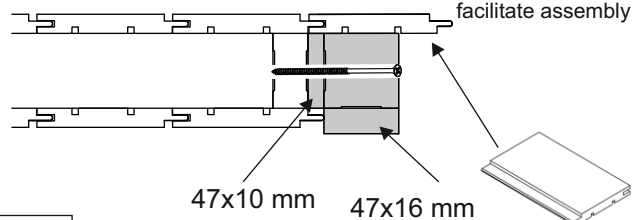
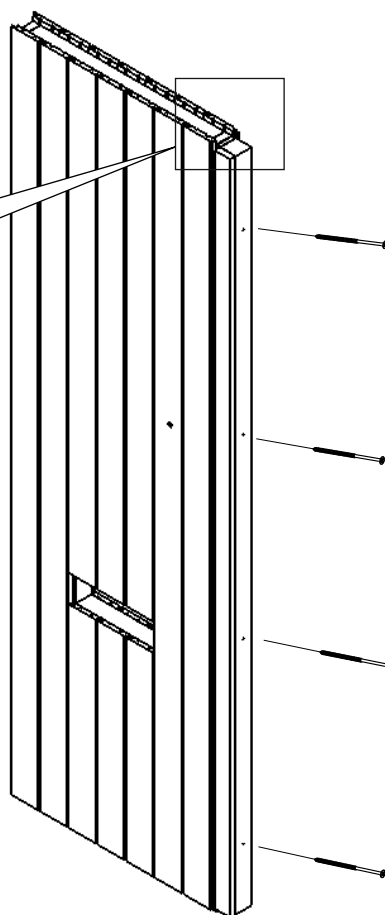
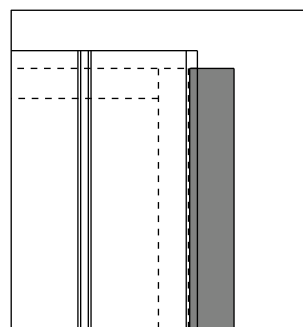

4

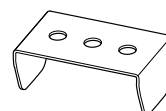
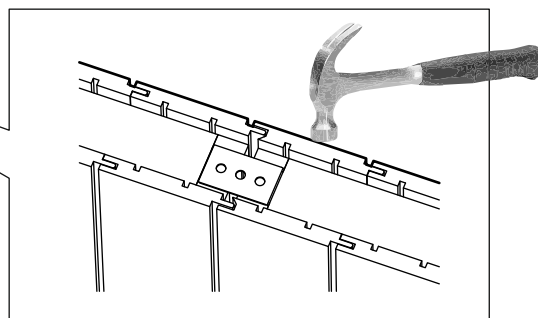
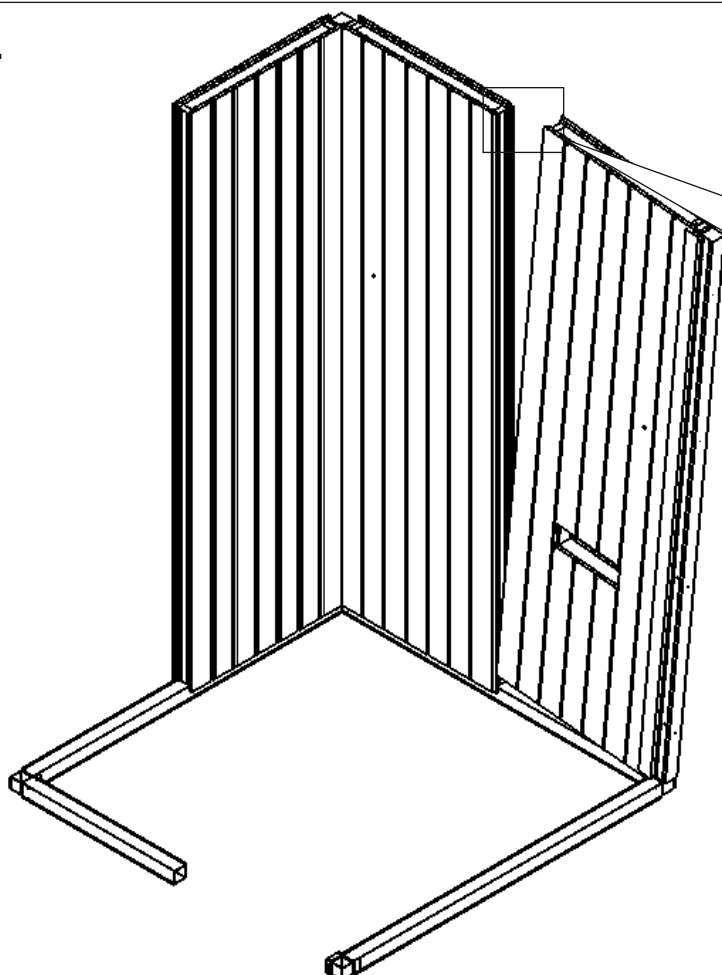

5

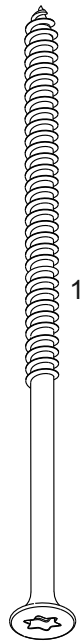

100mm

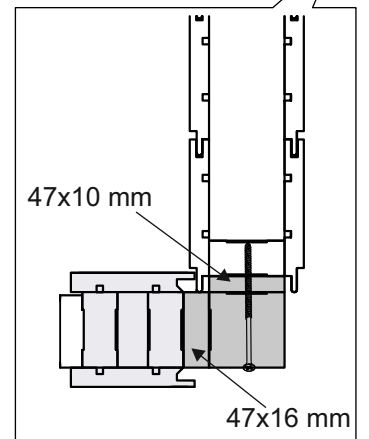
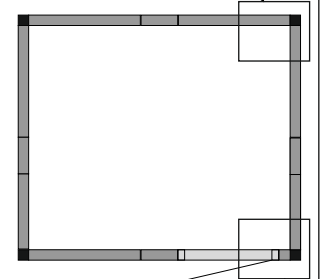
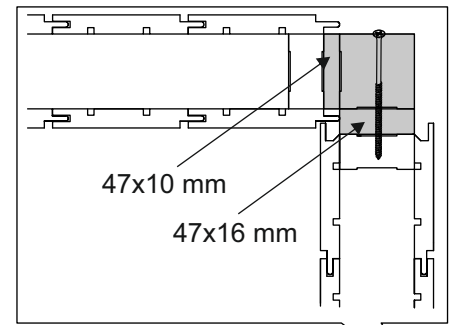
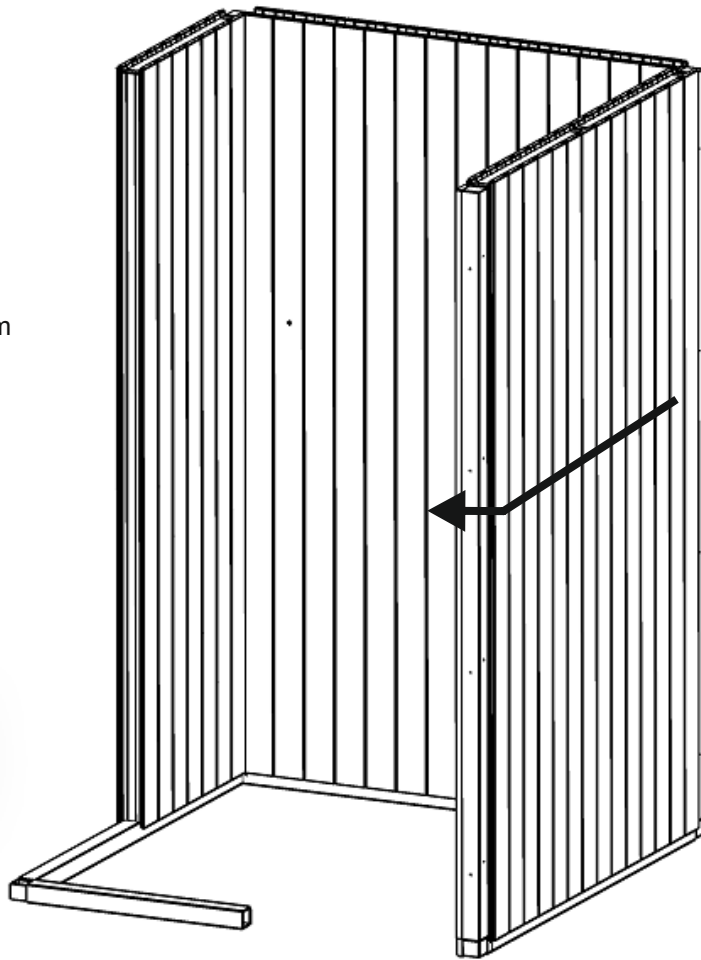

6

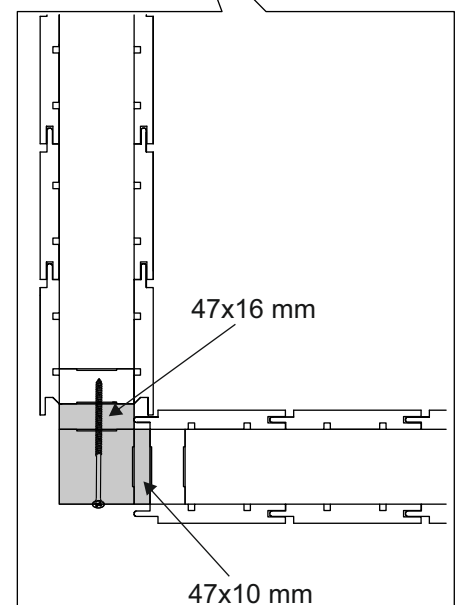
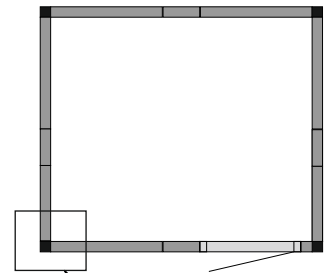
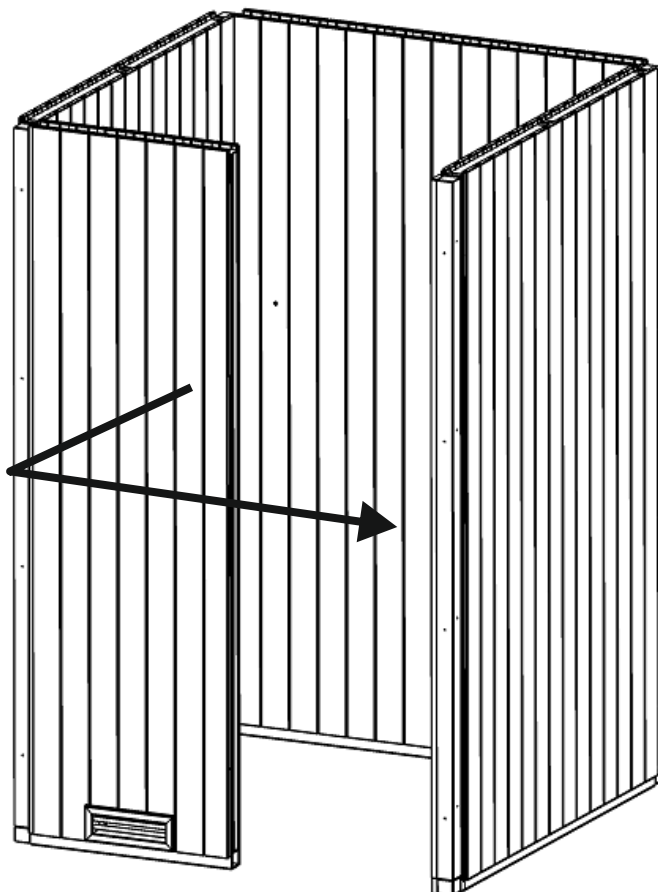

7

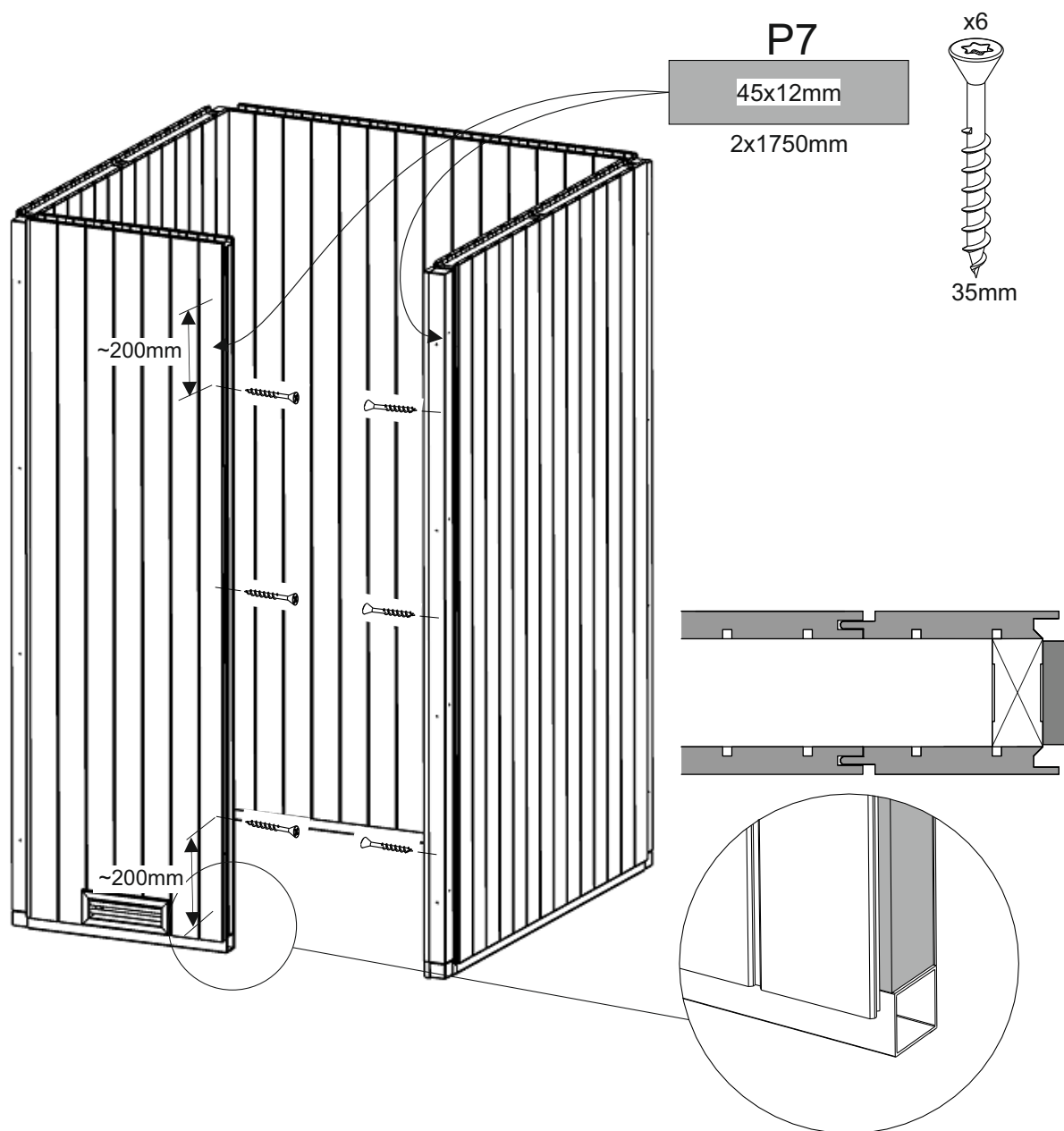

8

Door

Follow the instructions supplied with the door.

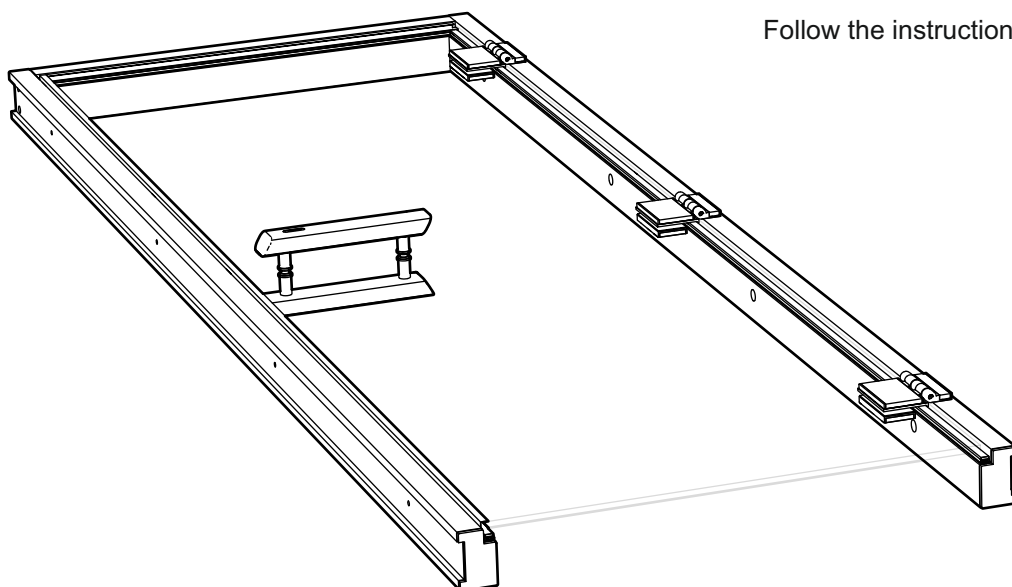

9

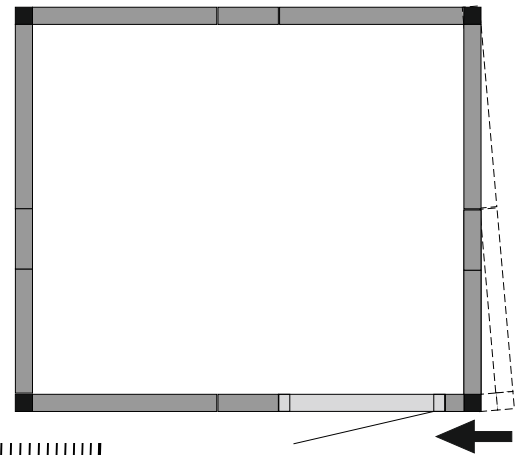
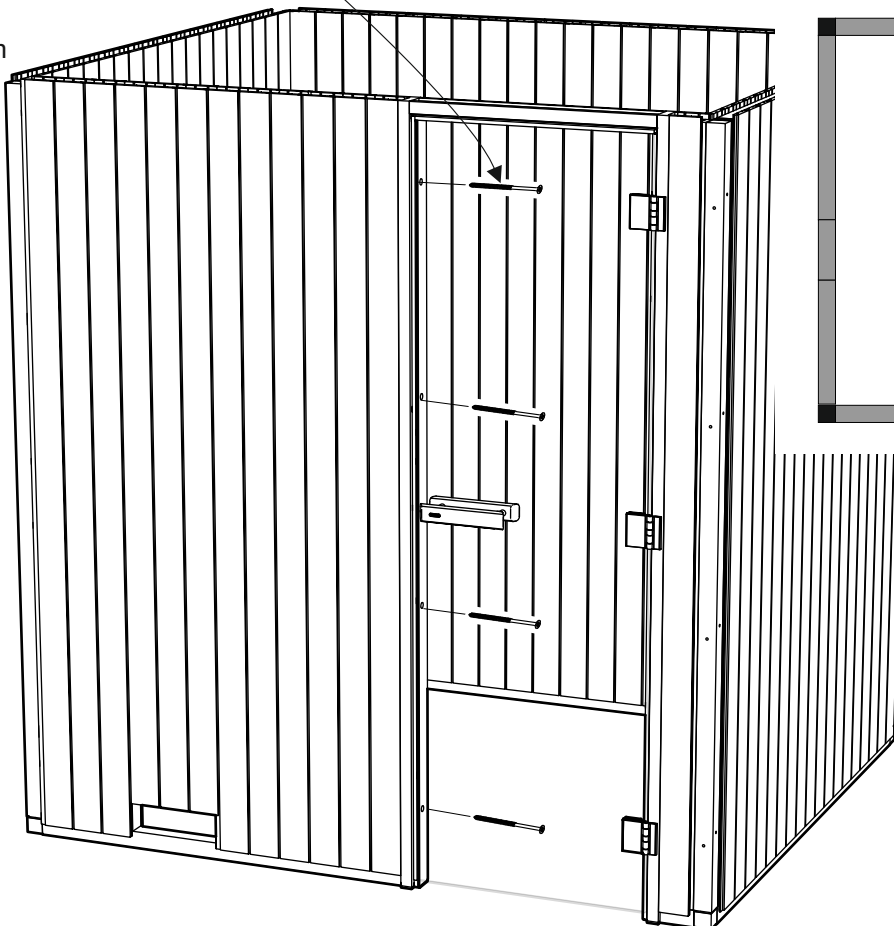
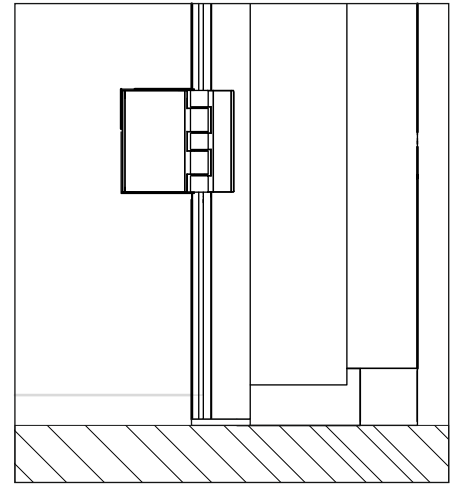
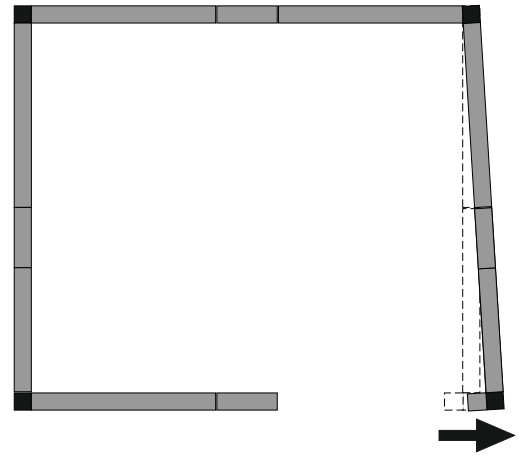
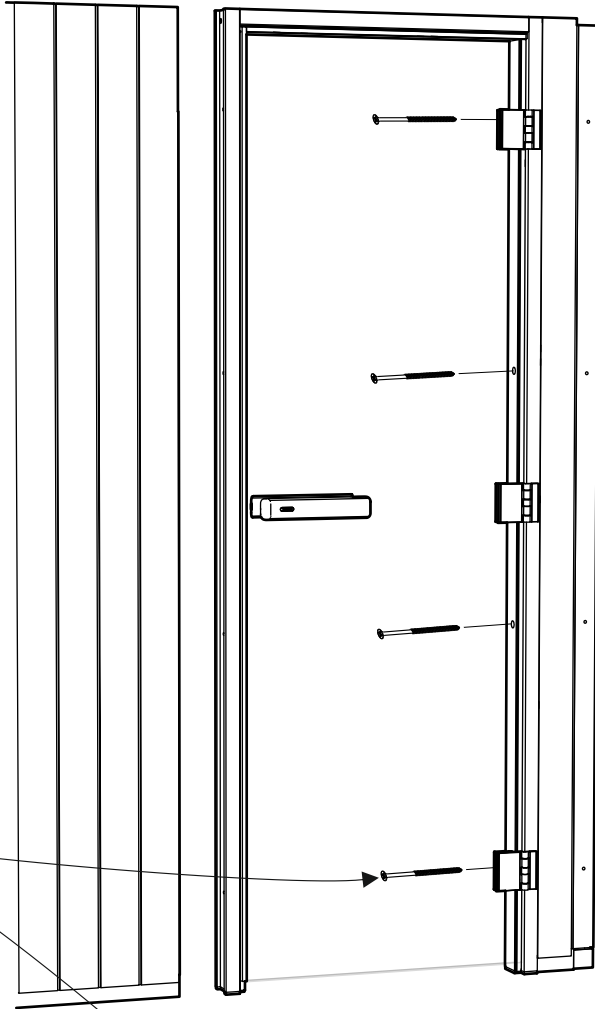
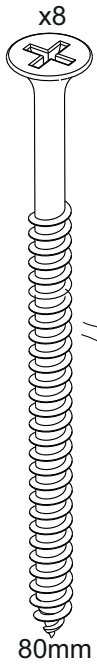

Ceilings

See page 7 for heater cabling instructions.

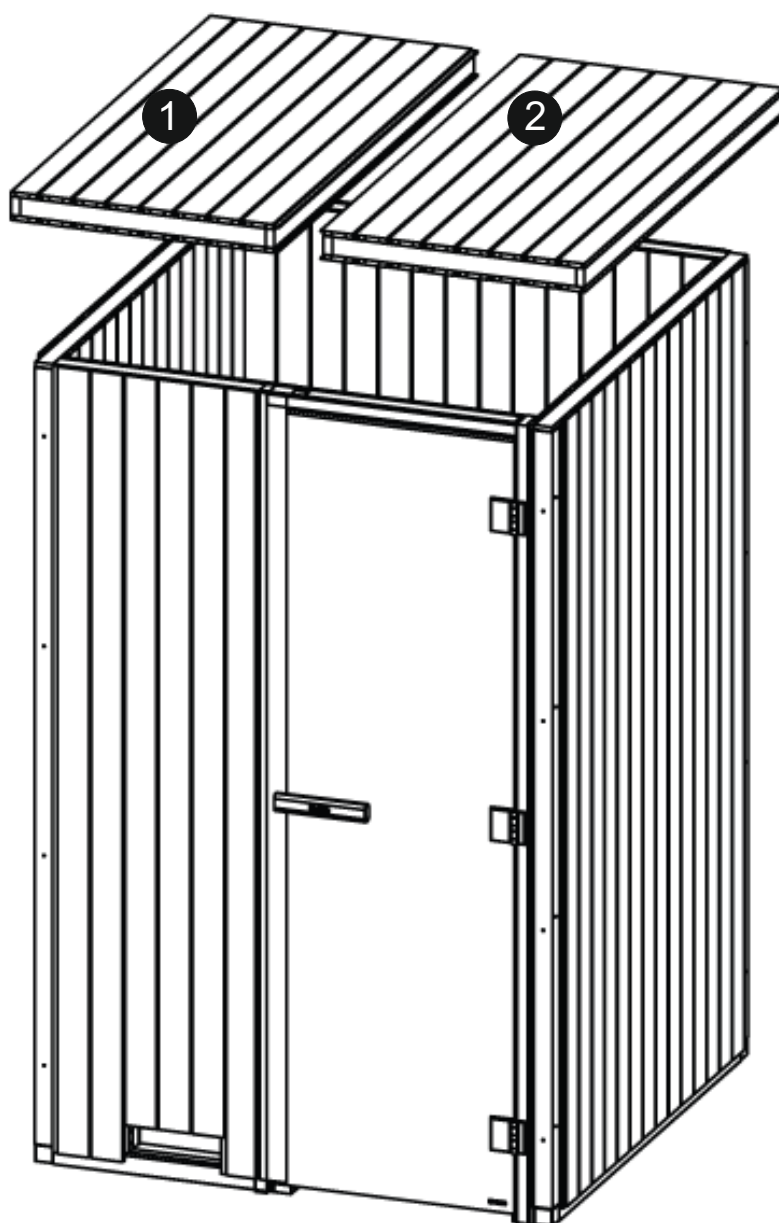
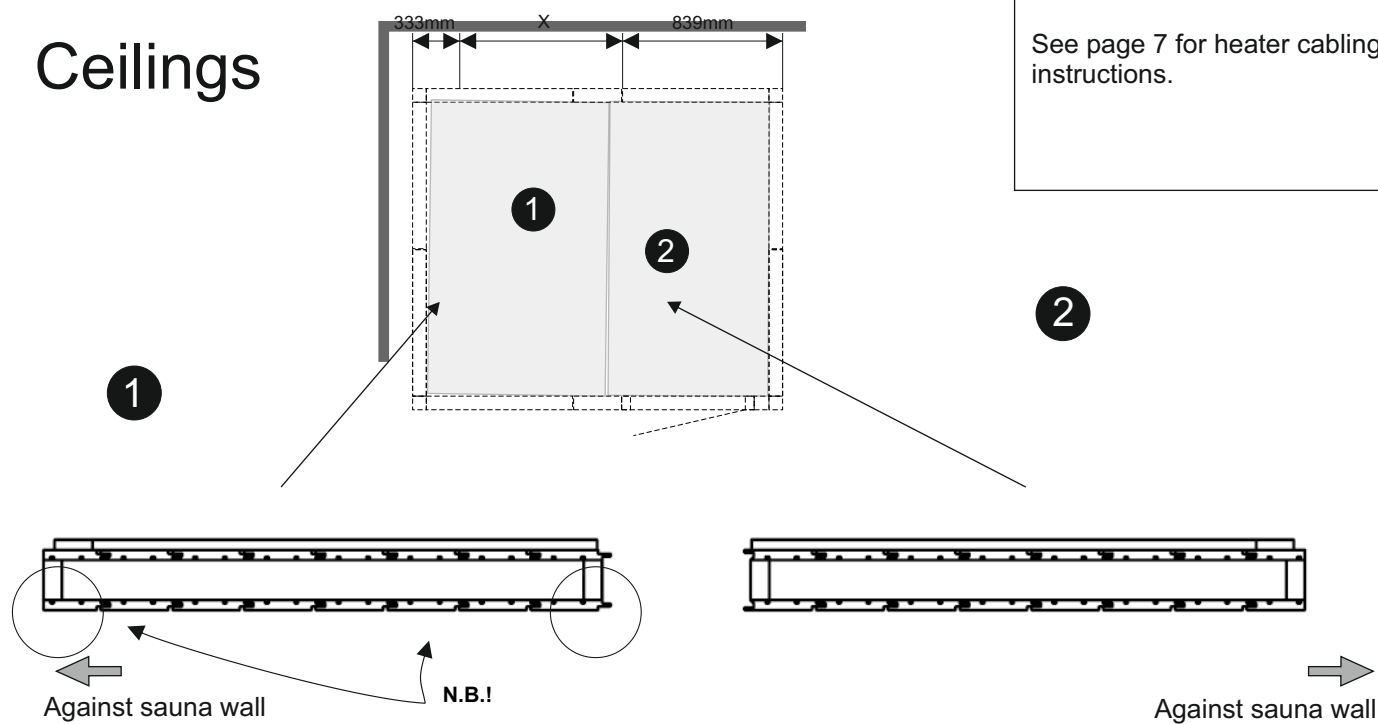

Ceilings, inside

NOTE! Make sure of correct alignment above the door.

P8

45x3.2x600mm

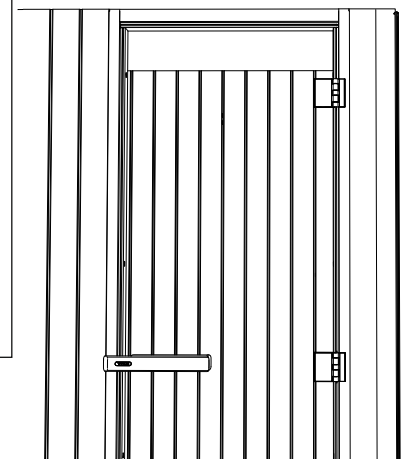
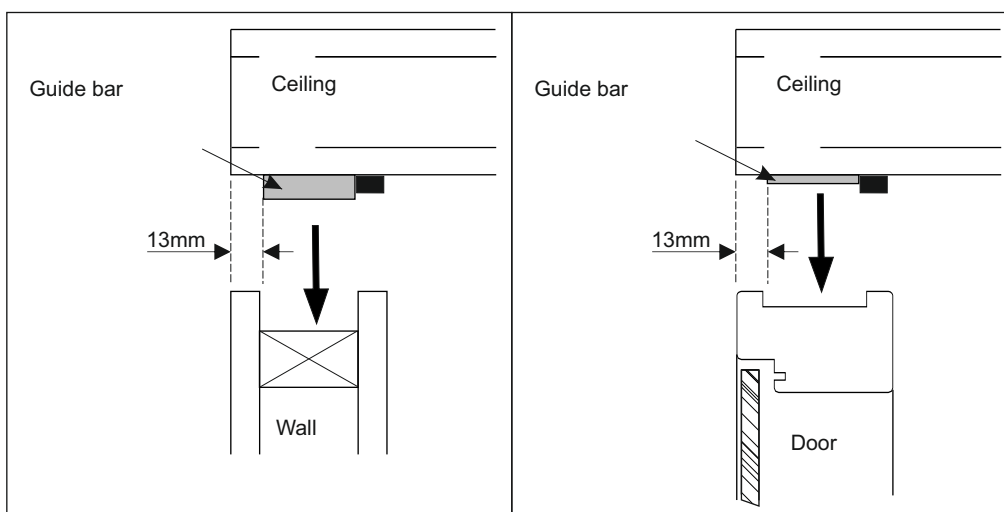
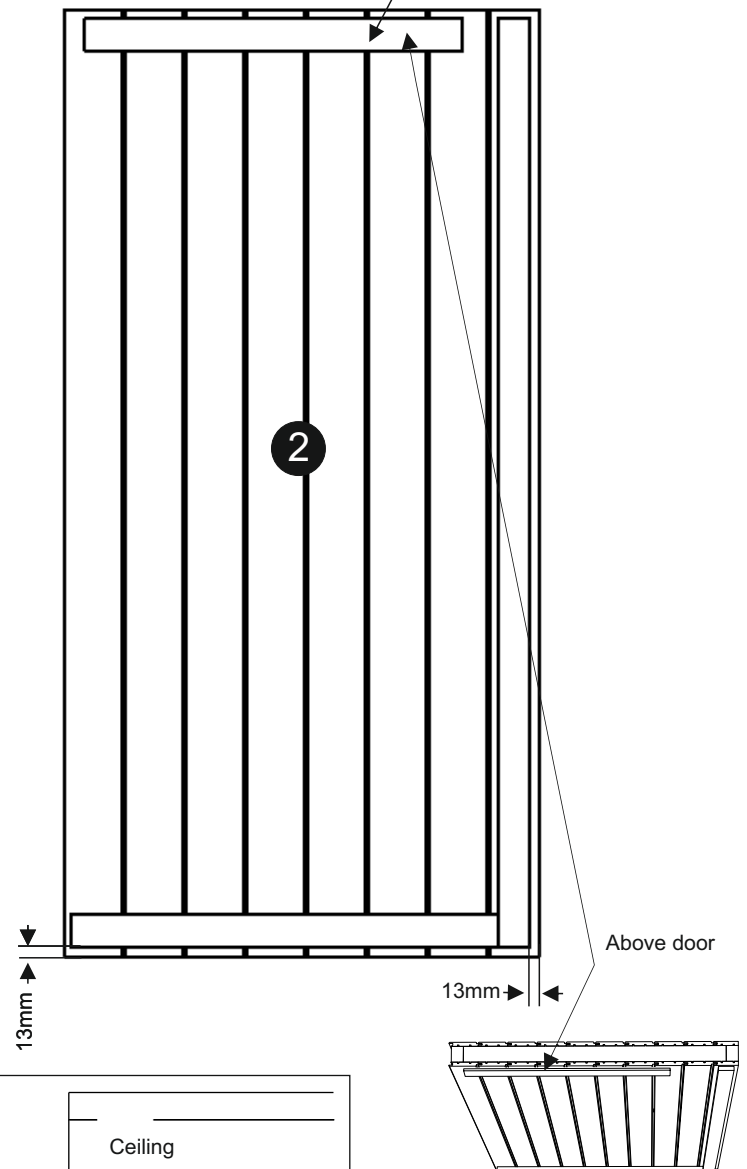
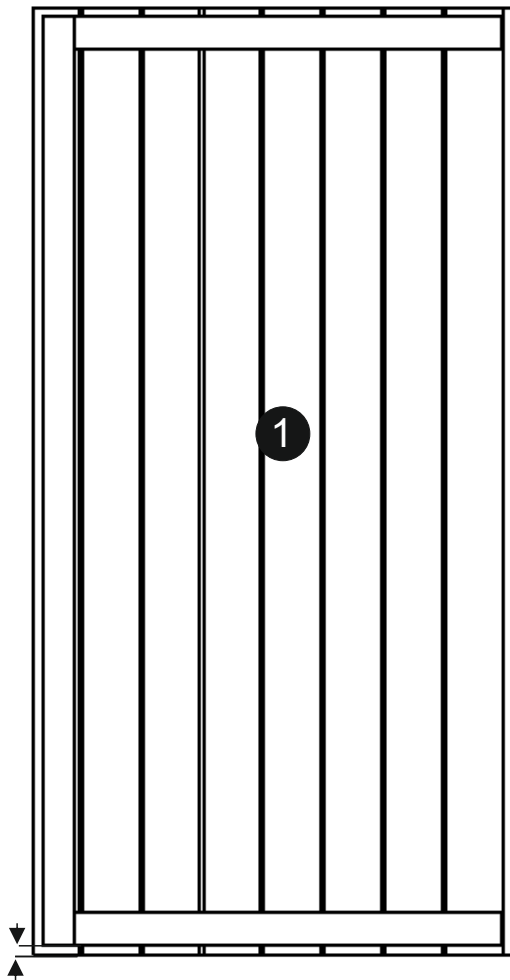

10

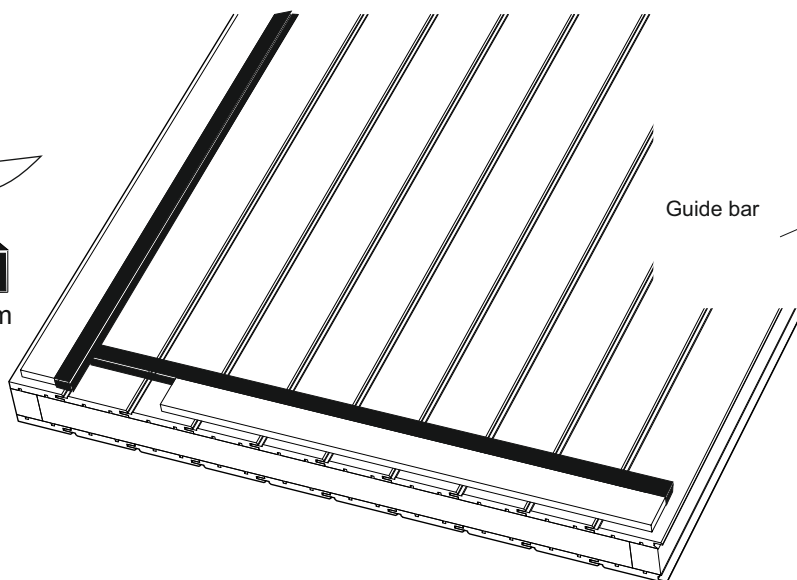
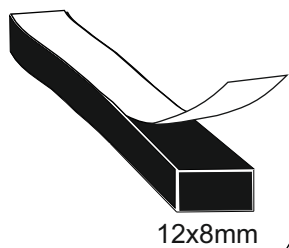

Guide bar

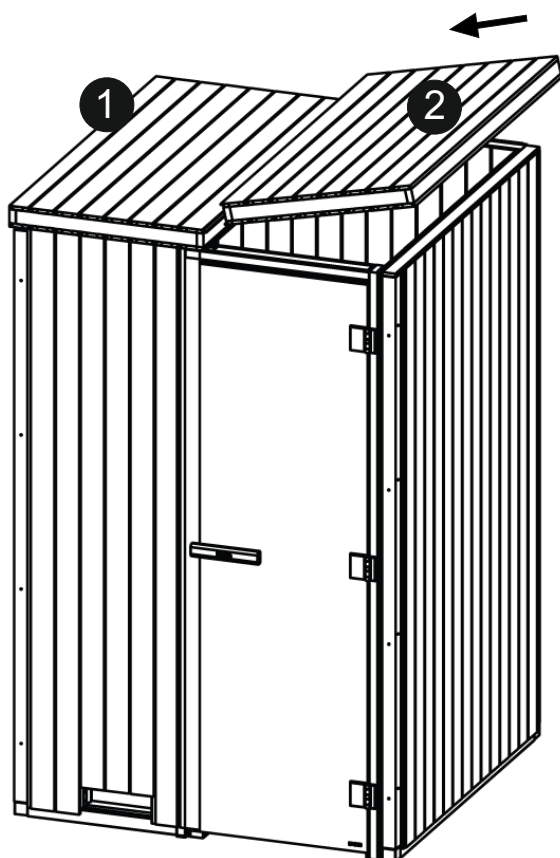
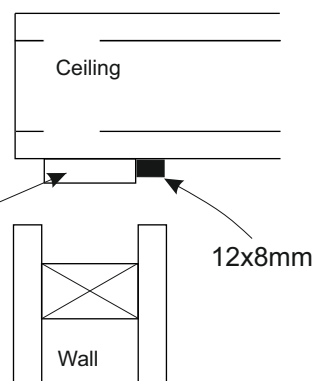

Option

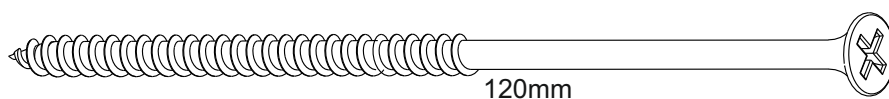
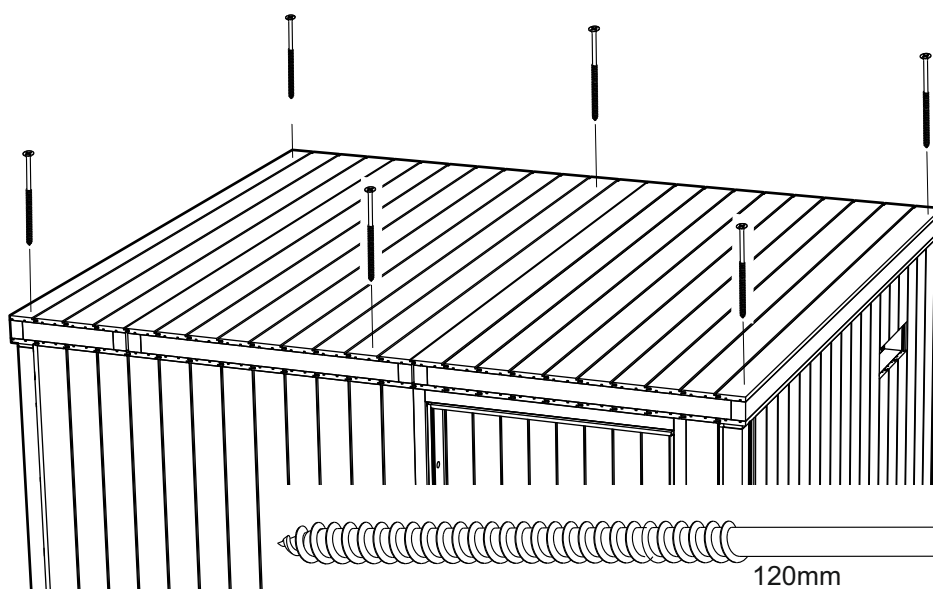

11

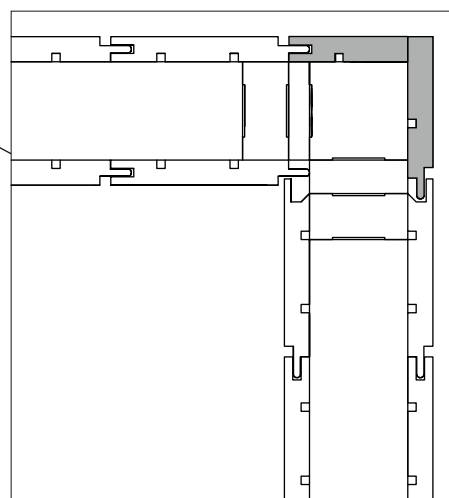
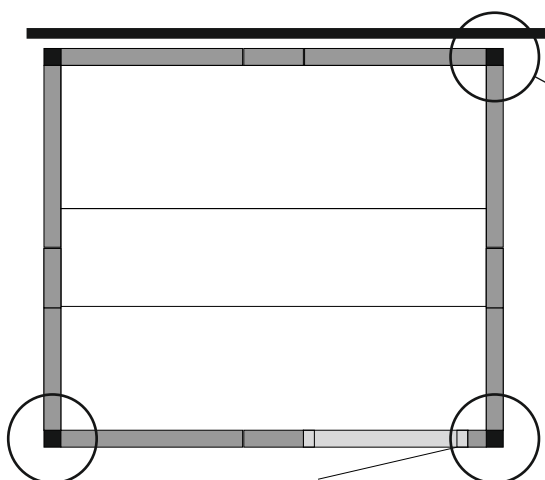
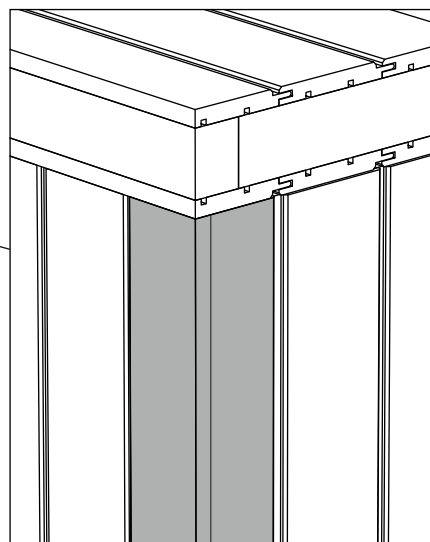
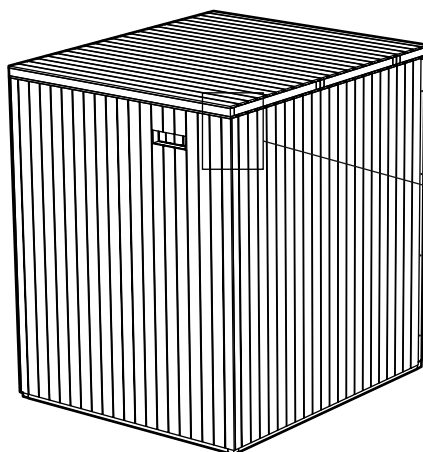
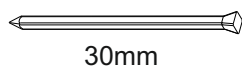
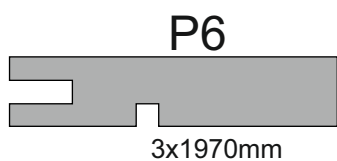
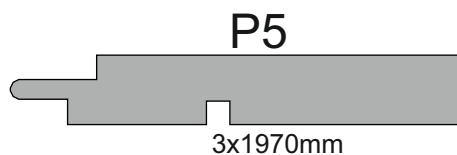

12

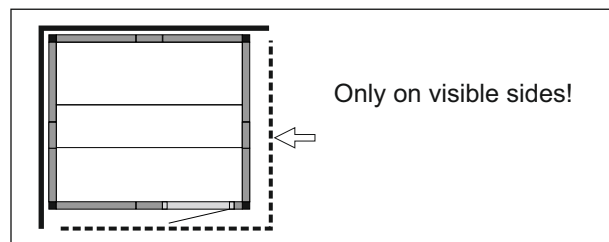
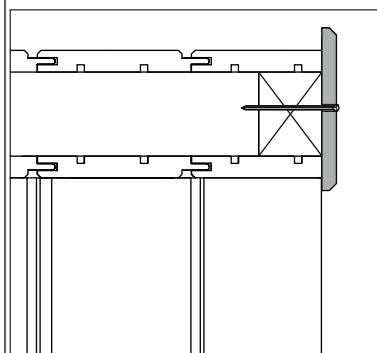
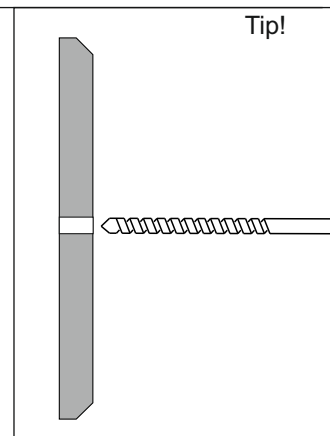
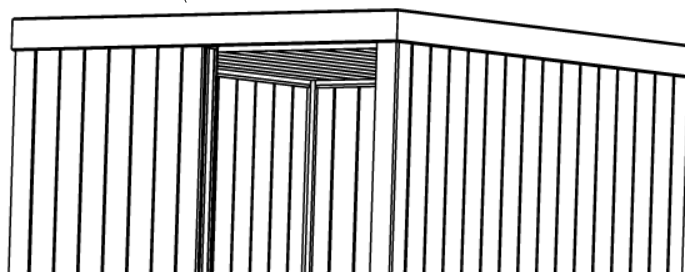
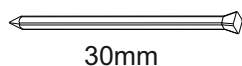
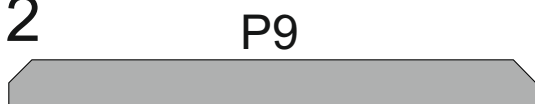

13

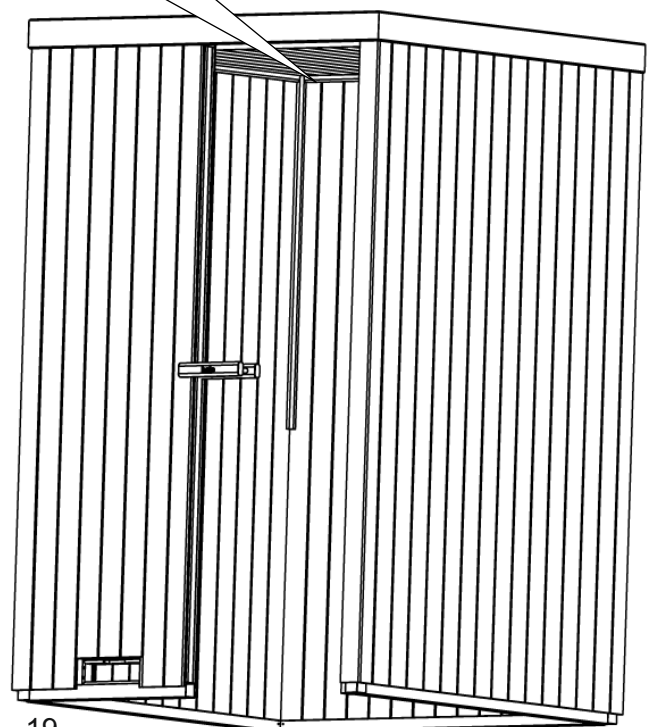
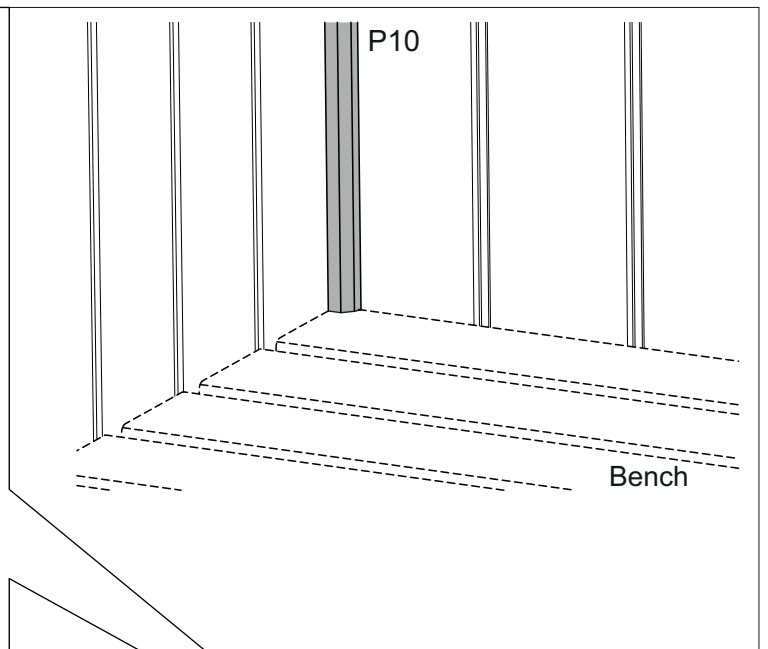
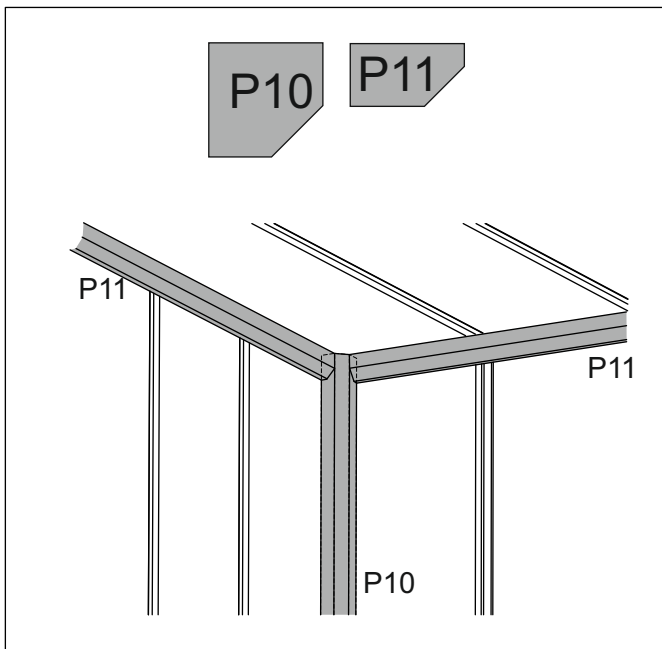
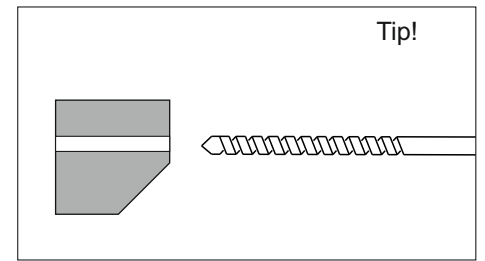
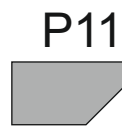
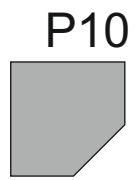
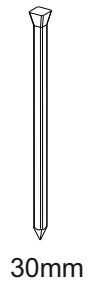

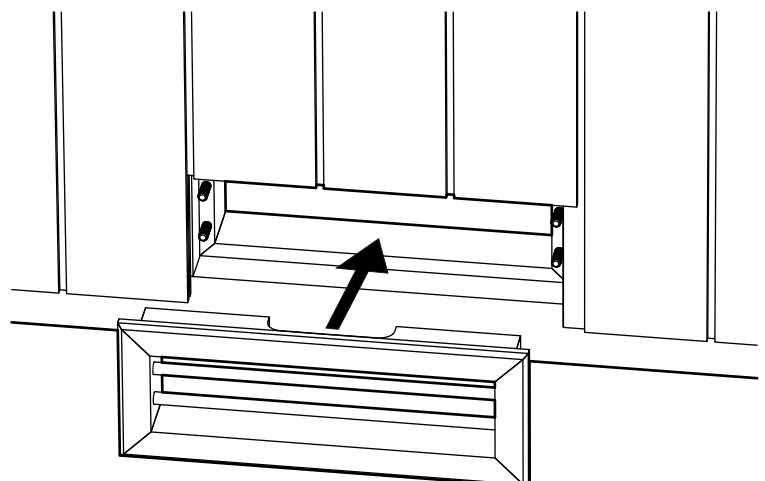
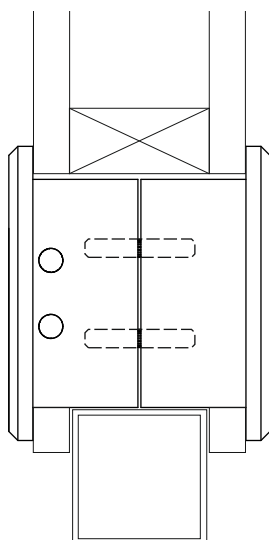
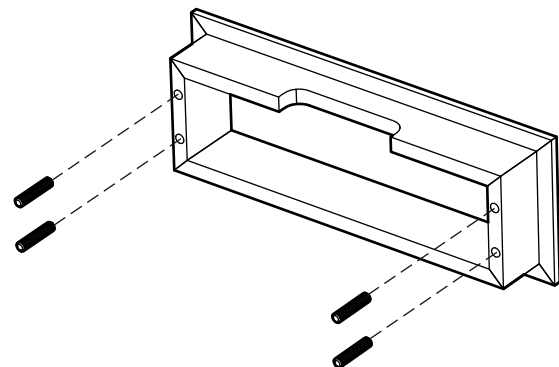
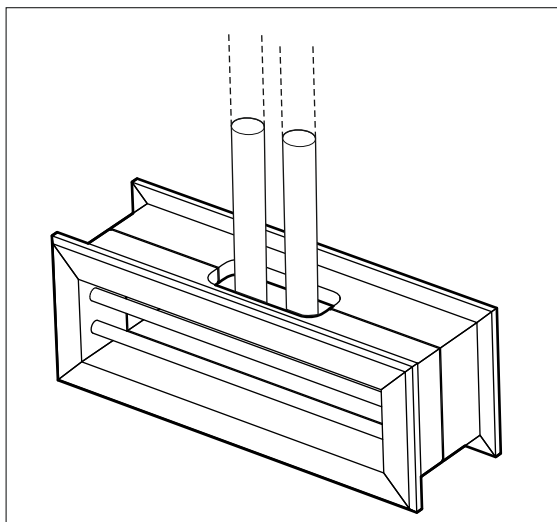
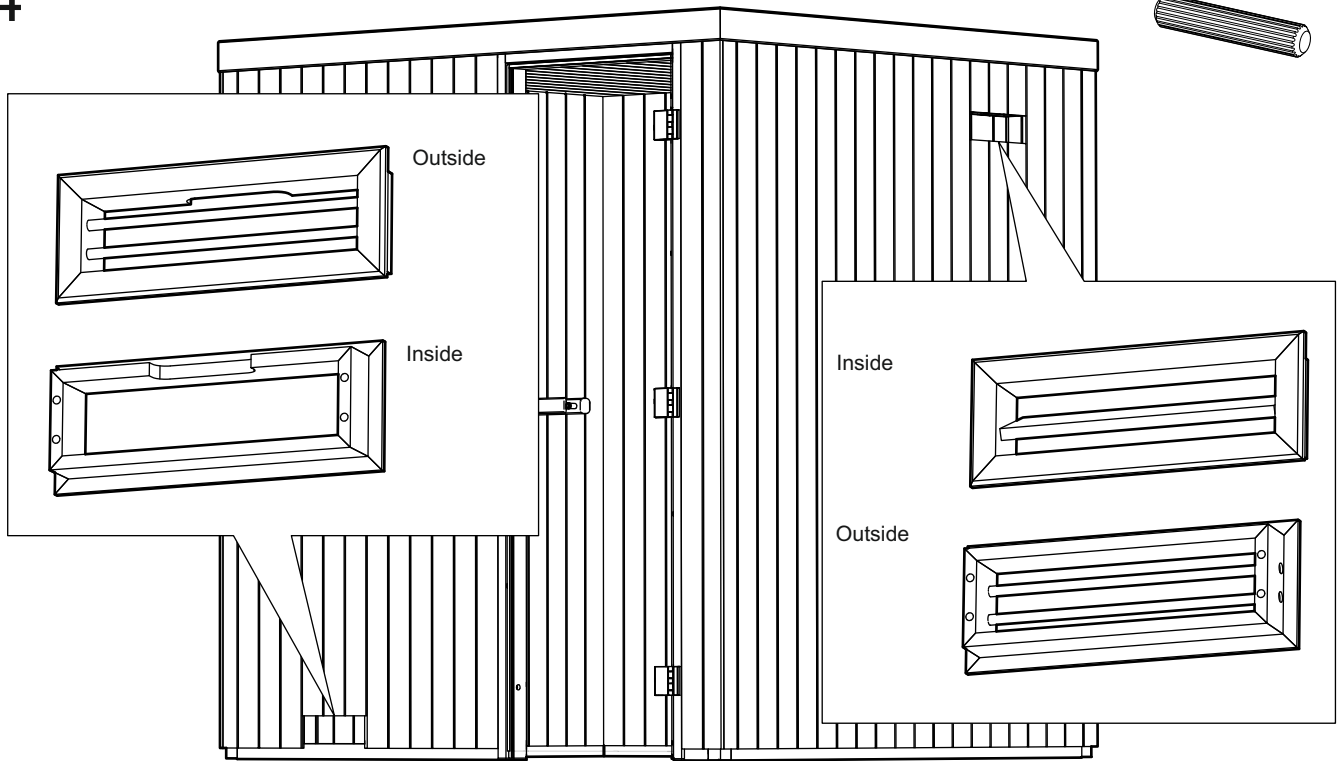
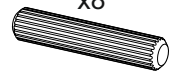

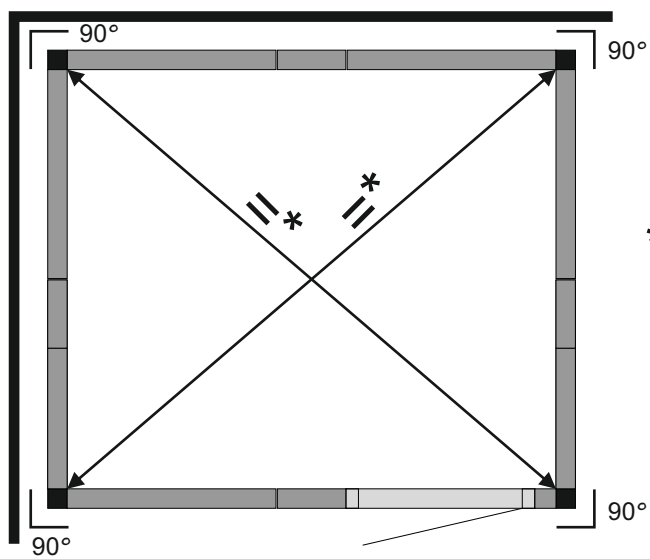

* The dimensions must be equal on the diagonals

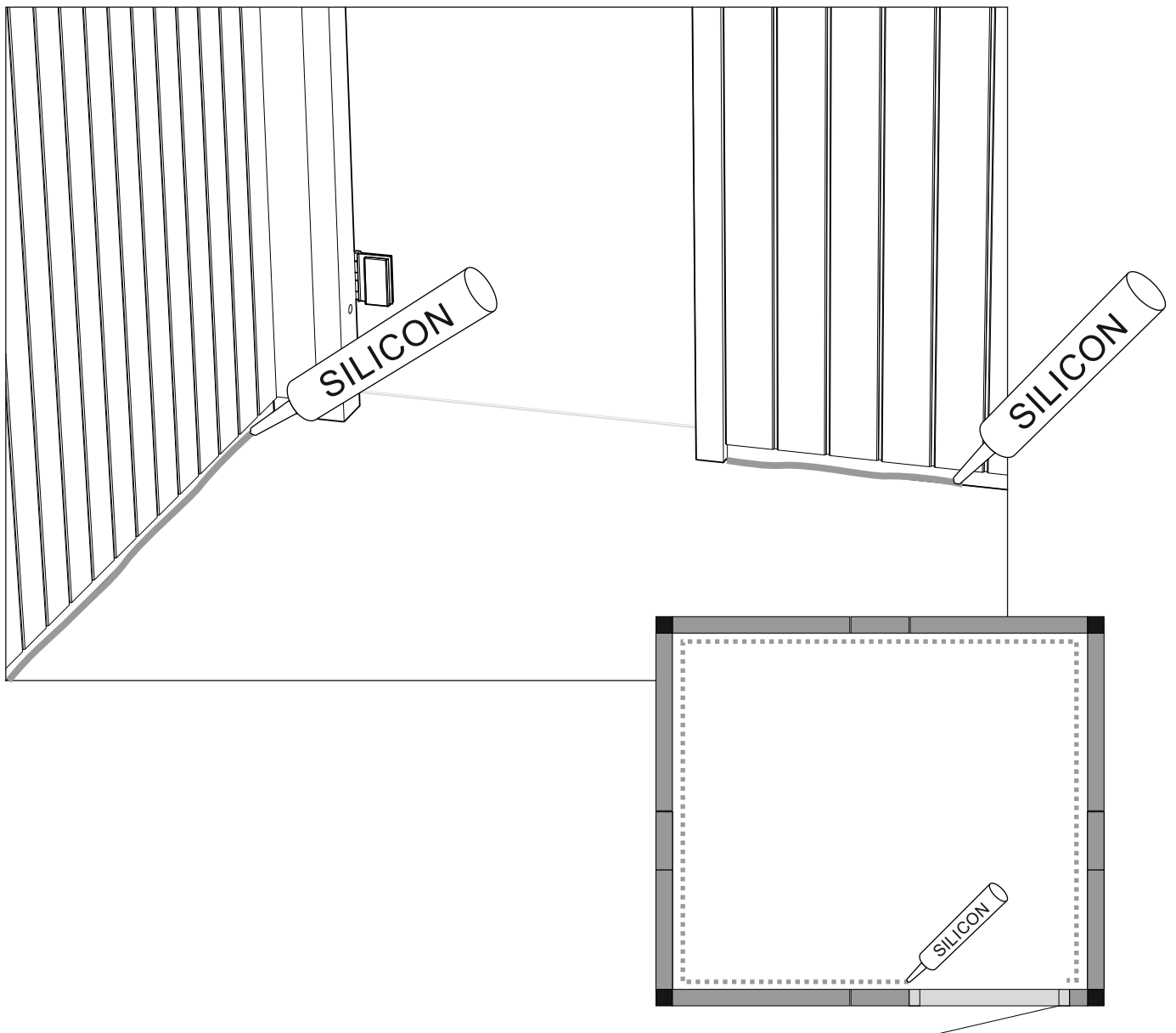

Benches

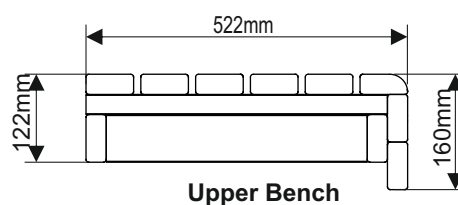
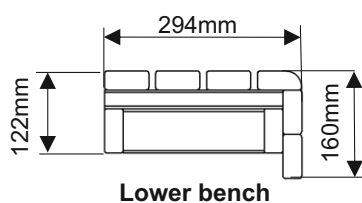
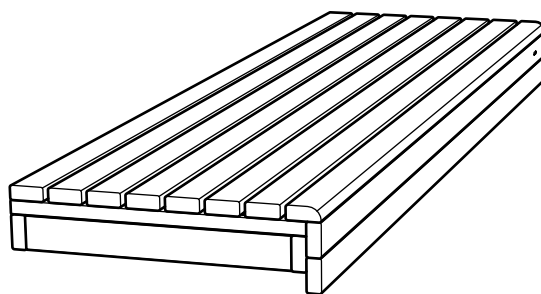

NOTE! Assemble the interior according to the safety distances in the heater's installation instructions.

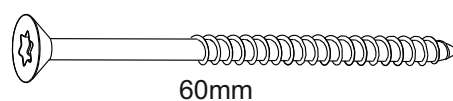
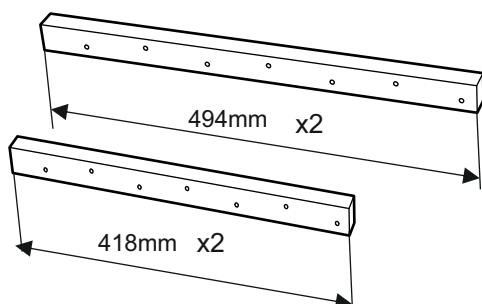

Bench supports:

Use 494mm long bench support for the upper bench. Follow guide markings on side walls for correct placement. Ensure the top supports extend to the backwall

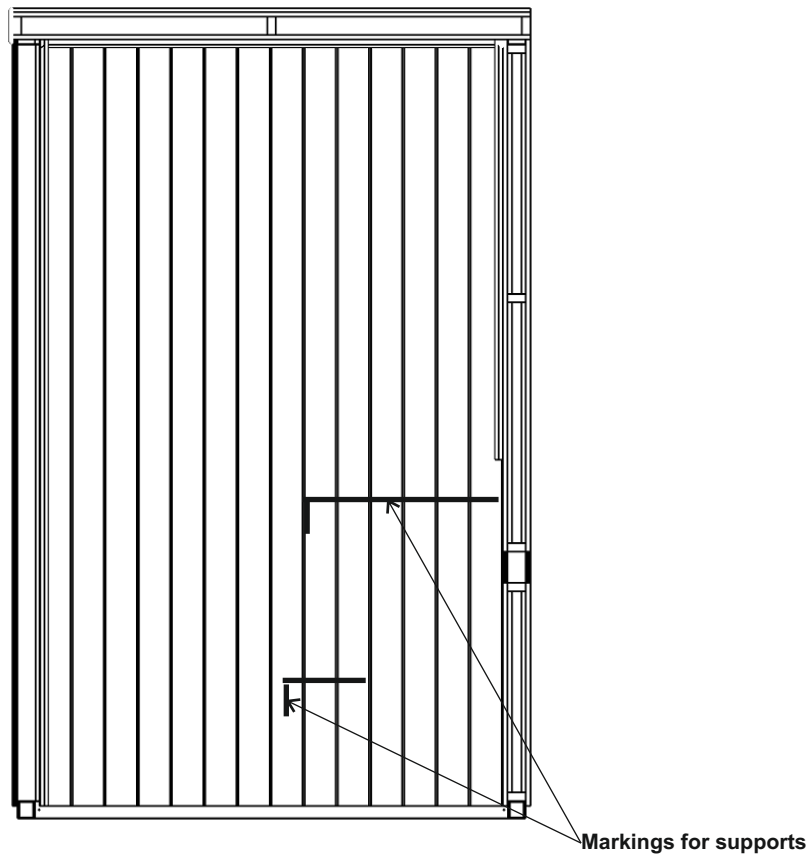

Glue and screw bench supports in place.
Make sure all screw holes are used!



16

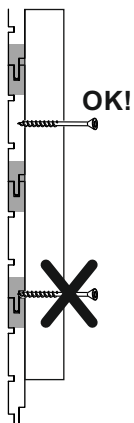

17

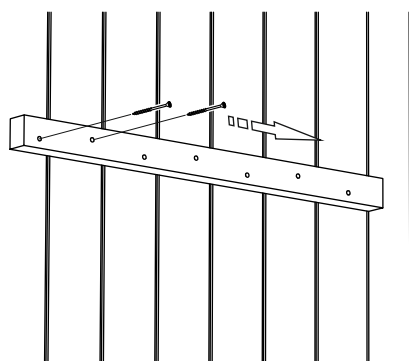
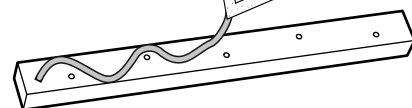

Repeat steps 16-18 on left hand side

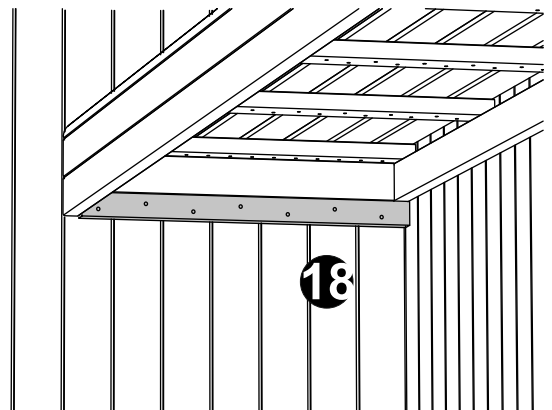

Repeat steps 19-21 on left hand side

Glue and screw bench supports in place.
Make sure all screw holes are used!

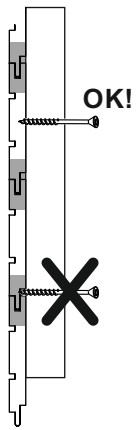

20

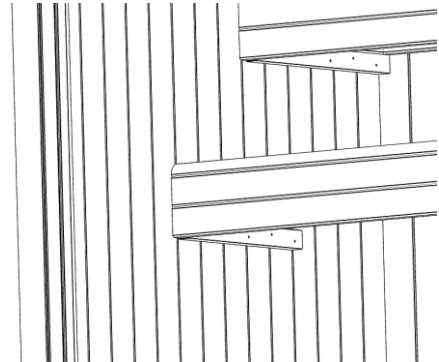
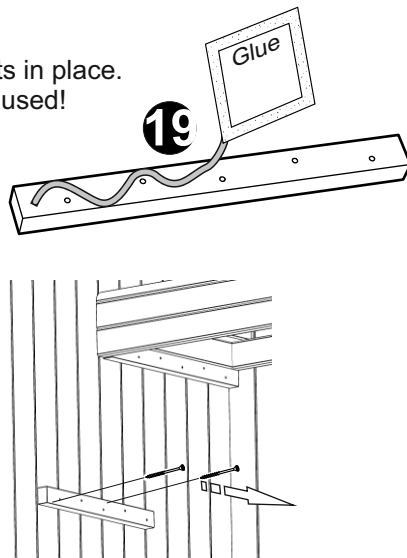

Secure the benches

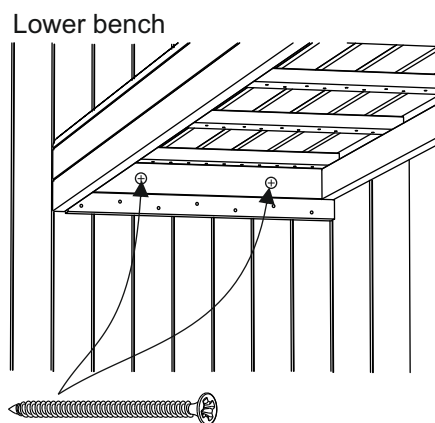
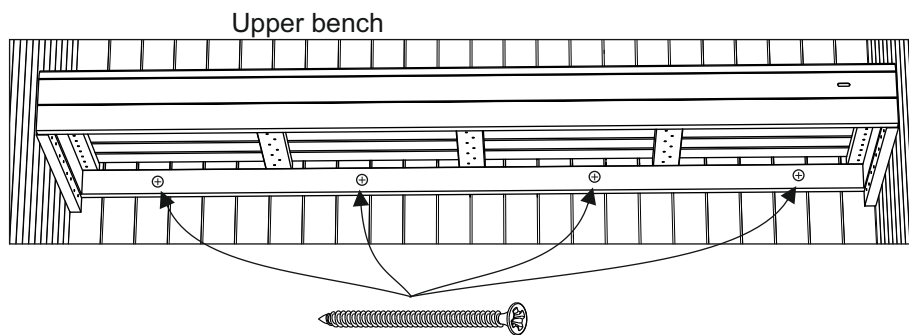

BACKREST

22

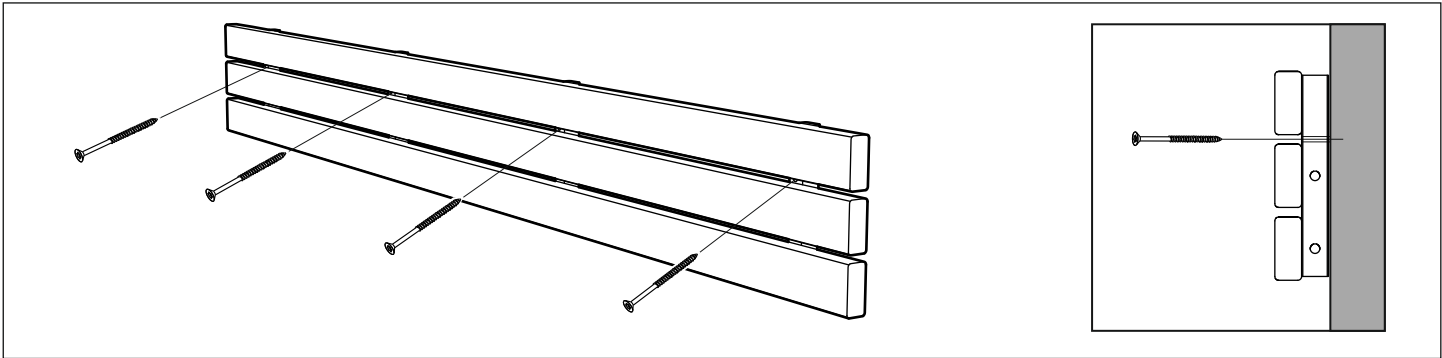
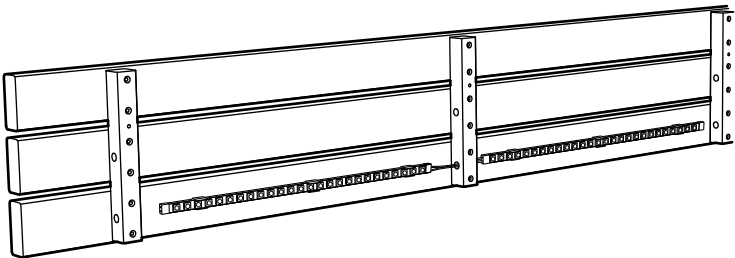
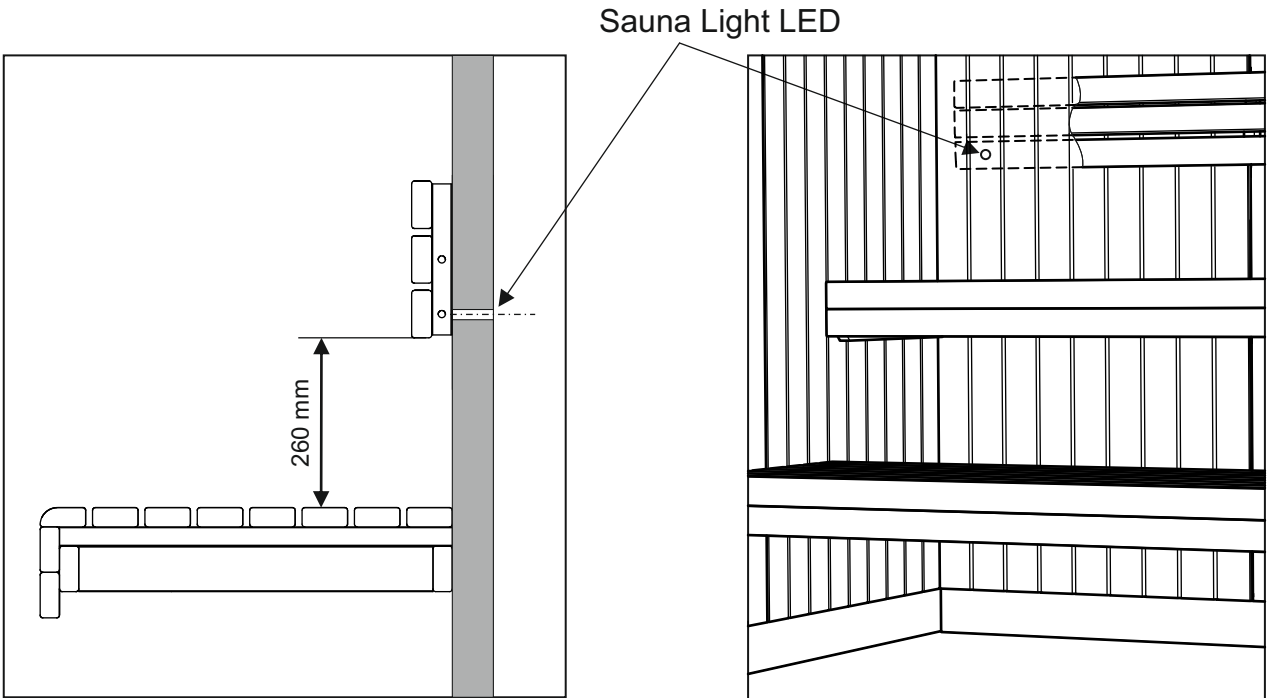
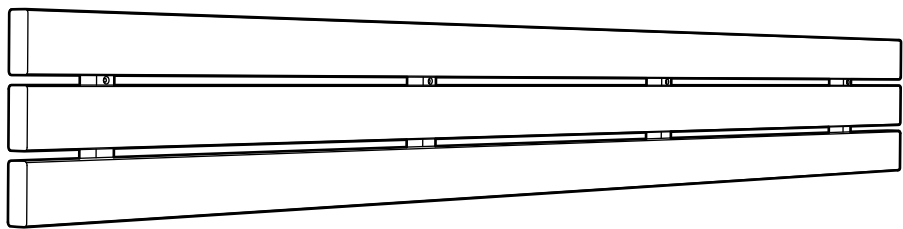

SKIRTINGS

23

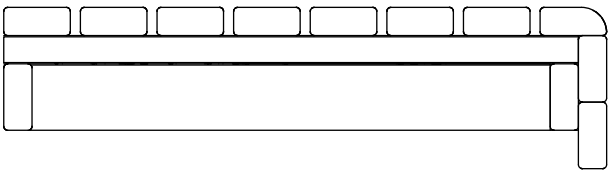
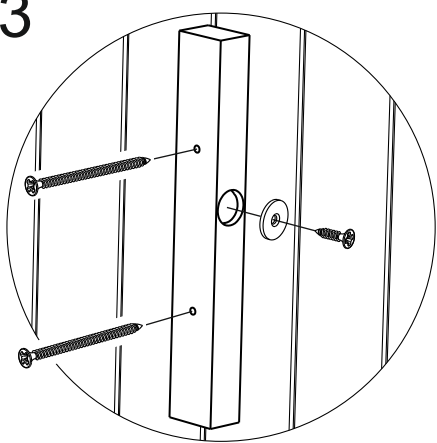

Use guide markings

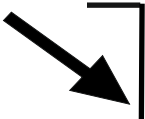

24

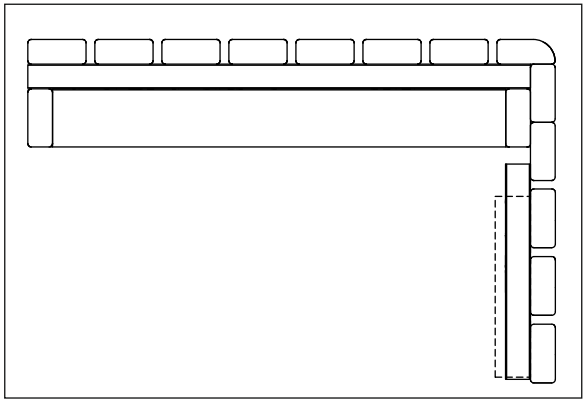
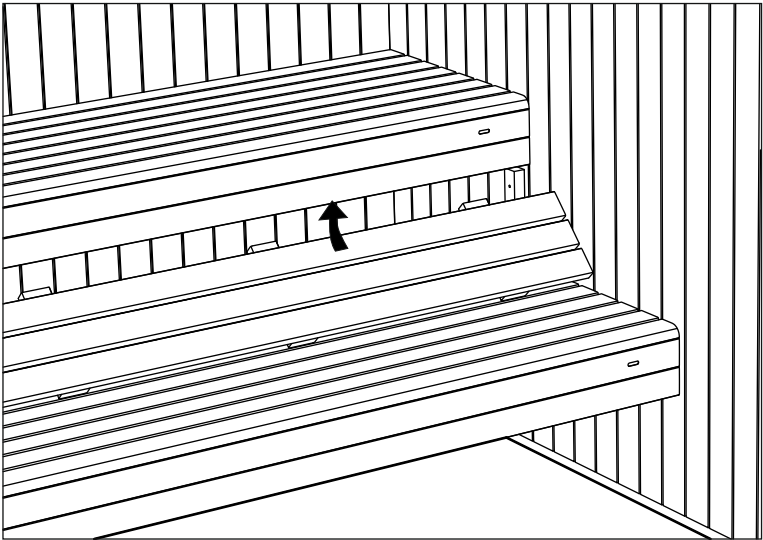
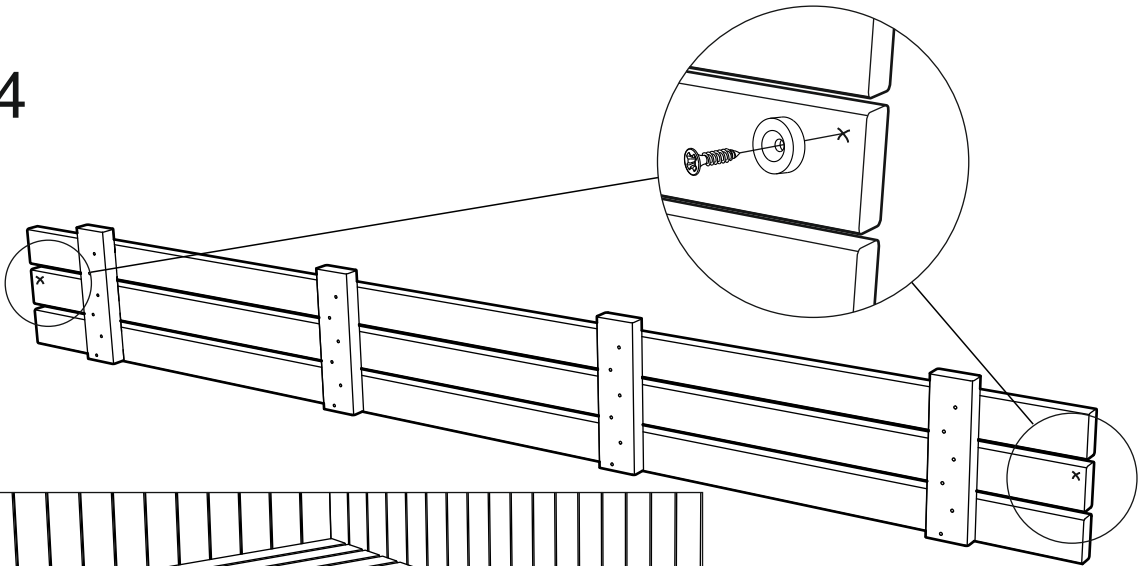

HEATER GUARD

See heater manual for safety distance and placement of heater guard

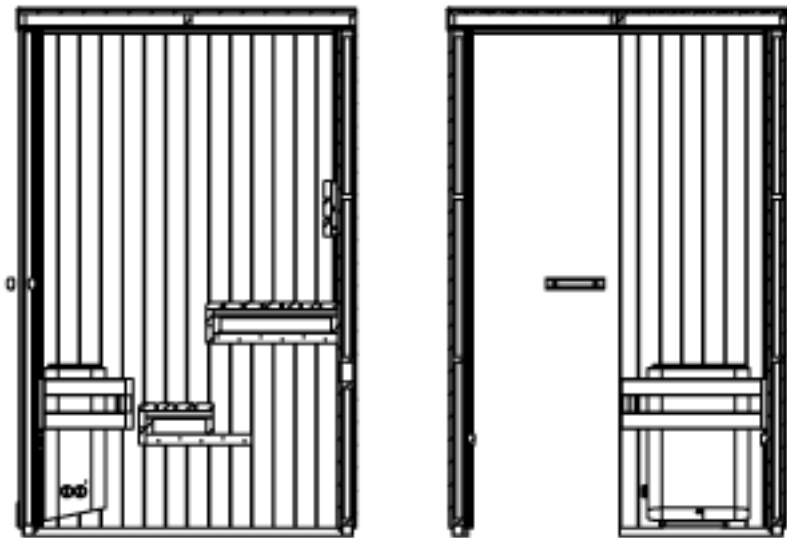

25

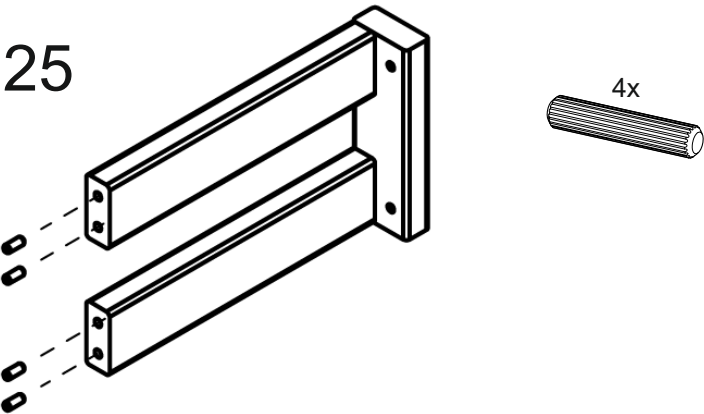

28

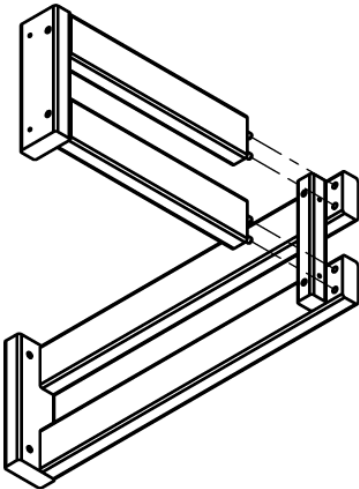

29

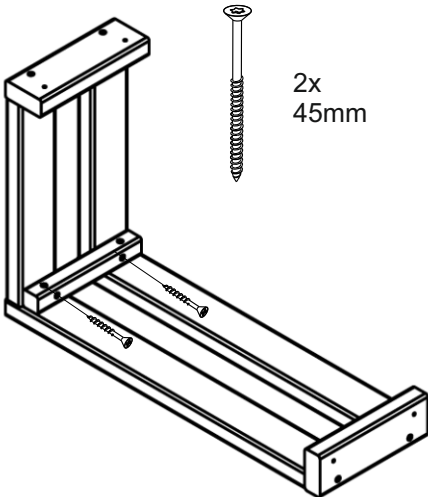

See heater manual for wall placement

29

